

BICYCLE MAP OTTER TAIL COUNTY MINNESOTA

PREPARED BY THE
MINNESOTA DEPARTMENT OF TRANSPORTATION
OFFICE OF TRANSPORTATION SYSTEM MANAGEMENT

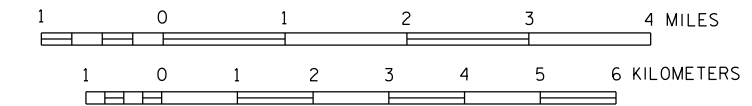

2016
BASIC DATA - 2015

Projection:
Minnesota Coordinate System
Central Zone
Lambert Conformal Conic

North American Datum
of 1983

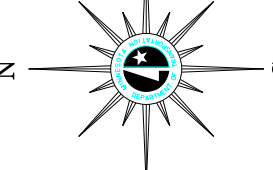

LEGEND

- Roadways with shoulders (less than 4 feet)
- 0-750 (less than 3 cars/mi)
- 751-2000 (3 cars/mi)
- 2001-10,000 (10 cars/mi)
- 10,000+ (10+ cars/mi)
- Gravel Roadway
- Federal, State and Regional Bicycle Trails
- Minnesota River Trail
- Interstate / Bicycle Prohibited
- State or National Forests

ROAD AND ROADWAY FEATURES

- PROJECTED ROAD
- PAVED ROAD
- GRAVEL AND GRAVEL ROAD
- CONDITIONAL TRAILING HILLSLAND
- GRAVEL OR STONE ROAD
- BITUMINOUS ROAD
- PAVED ROAD
- EASEMENT ROAD
- TRAIL HIGHWAY UNDER CONSTRUCTION
- ROAD IN UNDESIGNATED CORPUS
- EXTENSION OF LOCAL ROAD NOT FULLY RECONSTRUCTED AND FRONTAGE ROADS
- GRADE SEPARATION
- FULL TRAFFIC INTERCHANGE
- PARTIAL TRAFFIC INTERCHANGES
- INDICATING TRAFFIC HIGHWAYS

ROAD SYSTEM DESIGNATIONS

- INTERSTATE HIGHWAY
- U.S. NUMBERED TRAIL HIGHWAY
- STATE NUMBERED TRAIL HIGHWAY
- COUNTY STATE AID HIGHWAY
- COUNTY ROAD
- COUNTY STATE AID IN ADJACENT COUNTY
- DESIGNATION OF DESIGNATED ROUTE

BOUNDARIES

- NATIONAL OR STATE
- COUNTY
- CIVIL TOWNSHIP
- CORPORATE LINE
- SECTION LINE
- CONGESTED AREA
- DESIGN RESERVATION

DRAINAGE

- INTERMITTENT STREAM
- MAJOR STREAM
- WIDE STREAM
- SECTION LINE
- DRAINAGE BENCH
- LAKE OR POND

CITY CENTERS

- STATE CAPITAL
- COUNTY SEAT
- CITY CENTER
- INCORPORATED CITY GENERALIZED

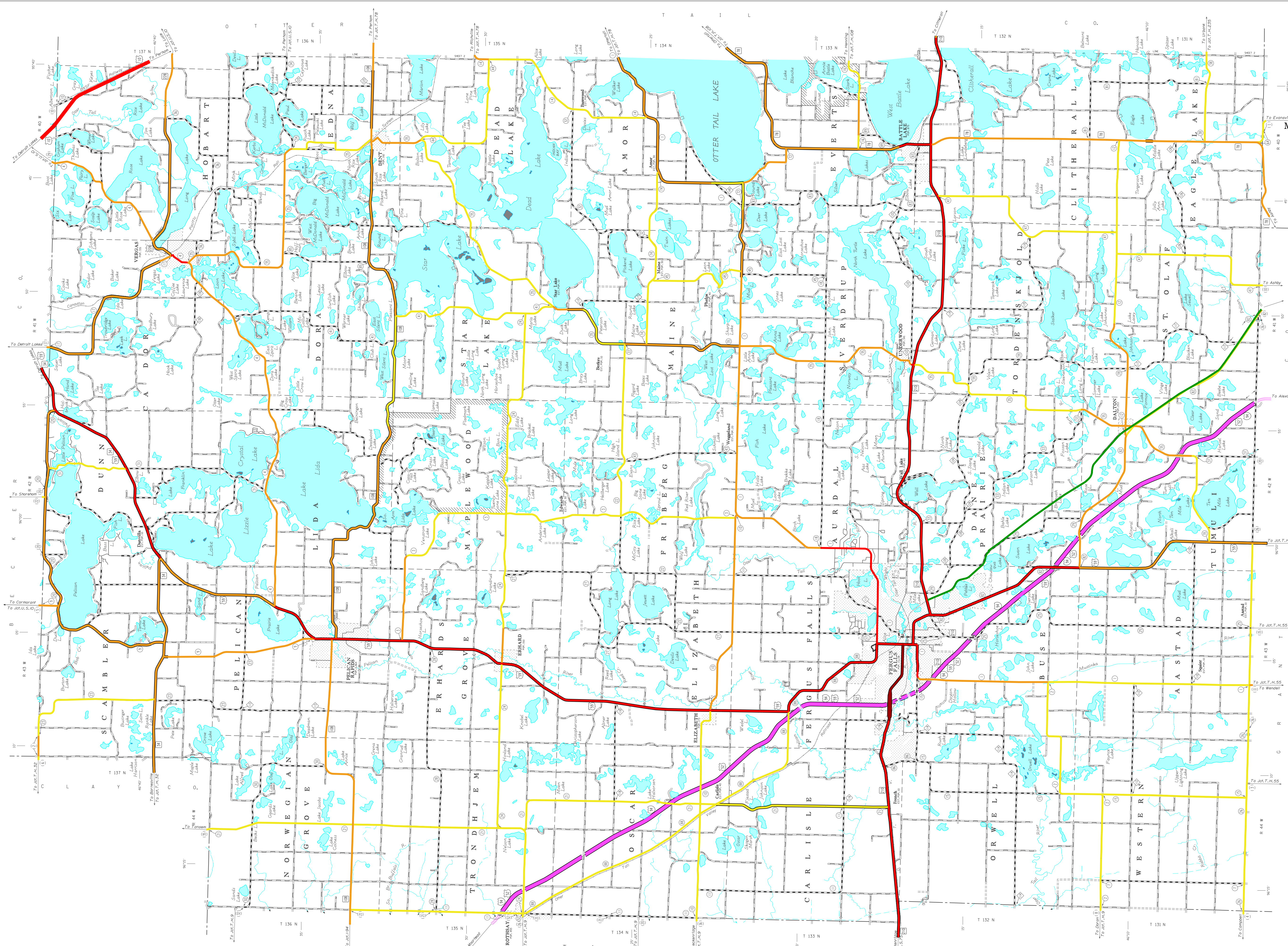
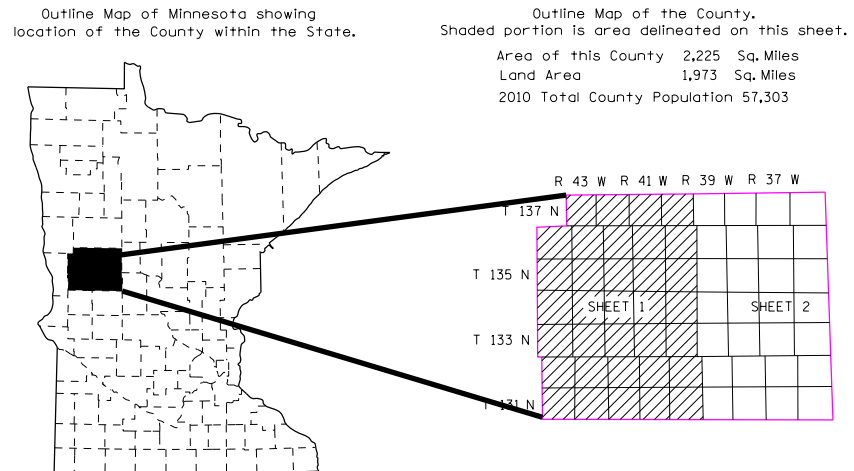

NOTE: FOR DETAIL OF COUNTY STATE AID HIGHWAYS AND COUNTY ROADS IN INCORPORATED PLACES, SEE MAPS OF MUNICIPALITIES.

BICYCLE MAP OTTER TAIL COUNTY MINNESOTA

PREPARED BY THE
MINNESOTA DEPARTMENT OF TRANSPORTATION
OFFICE OF TRANSPORTATION SYSTEM MANAGEMENT



2016
BASIC DATA - 2014

Projection: Minnesota Coordinate System
Central Zone
Lambert Conformal Conic
North American Datum of 1983

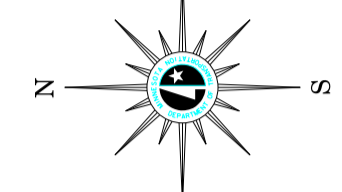

LEGEND

- | | | | | | |
|--|--|-------------------------|----------------------------------|---------------------------|---|
| (Roadways with shoulders less than 4 feet) | 0-750 (Fewer than 3 cars / min) | 751-2500 (3 cars / min) | 2501-10,000 (12 cars / min) | 10,000+ (24+ cars / min) | (Roadways with shoulders greater than 4 feet) |
| Gravel Roadway | Federal, State and Regional Bicycle Trails | Mississippi River Trail | Interstate / Bicycles Prohibited | State or National Forests | |

ROAD AND ROADWAY FEATURES

- PROJECTED ROAD
- PRIMITIVE ROAD
- GRADED AND DRAINED ROAD
- SOIL SURFACE ROAD
- GRAVEL OR STONE ROAD
- BITUMINOUS ROAD
- PAVED ROAD
- DIVIDED ROAD
- TRUNK HIGHWAY UNDER CONSTRUCTION
- ROADS IN UNINCORPORATED COMPACTS, EXTENSIONS OF LOCAL ROADS (NOT F.A.S.) WITHIN MUNICIPALITIES AND FRONTAGE ROADS
- GRADE SEPARATION
- FULL TRAFFIC INTERCHANGE
- PARTIAL TRAFFIC INTERCHANGES INDICATING TRAFFIC MOVEMENT

ROAD SYSTEM DESIGNATIONS

- INTERSTATE TRUNK HIGHWAY
- U.S. NUMBERED TRUNK HIGHWAY
- STATE NUMBERED TRUNK HIGHWAY
- COUNTY STATE AID HIGHWAY
- COUNTY ROAD
- COUNTY STATE AID IN ADJOINING COUNTY
- TERMINATION OF DESIGNATED ROUTE

BOUNDARIES

- NATIONAL OR STATE
- COUNTY
- CIVIL TOWNSHIP
- CONGRESSIONAL TOWNSHIP (U.S. LAND)
- CORPORATE LINE
- SECTION LINE
- CONGESTED AREA
- INDIAN RESERVATION

DRAINAGE

- INTERMITTENT STREAM
- NARROW STREAM
- WIDE STREAM
- MARSH OR SWAMP LAND
- DRAINAGE DITCH
- LAKE OR POND

CITY CENTERS

- STATE CAPITAL
- COUNTY SEAT
- CITY CENTER
- INCORPORATED CITY (GENERALIZED)

Outline Map of Minnesota showing location of the County within the State. Area of this County 2,225 Sq. Miles
Land Area 1,973 Sq. Miles
2010 Total County Population 51,503

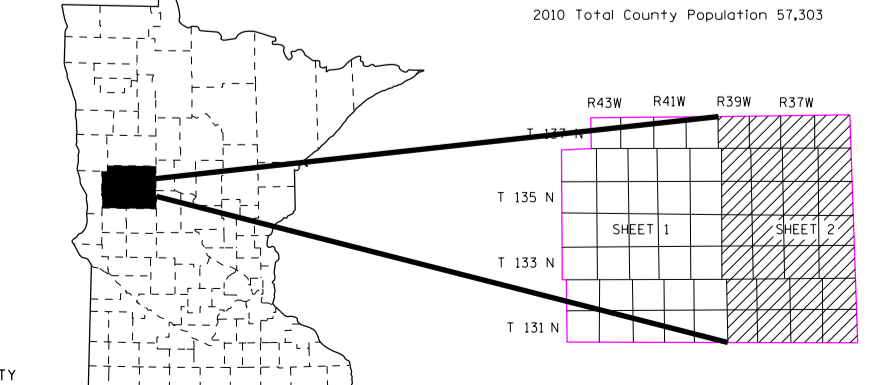

NOTE: FOR DETAIL OF COUNTY STATE AID HIGHWAYS AND COUNTY ROADS IN INCORPORATED PLACES, SEE MAPS OF MUNICIPALITIES.