

MUNICIPALITY OF BETHEL

PREPARED BY THE
MINNESOTA DEPARTMENT OF TRANSPORTATION
OFFICE OF TRANSPORTATION SYSTEM MANAGEMENT

IN COOPERATION WITH
U.S. DEPARTMENT OF TRANSPORTATION
FEDERAL HIGHWAY ADMINISTRATION

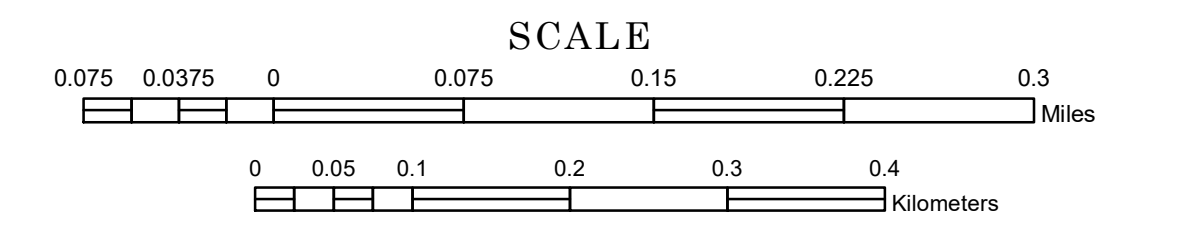

1 in = 400 ft

2024

Projection:
Transverse Mercator
NAD 1986
UTM Zone 15

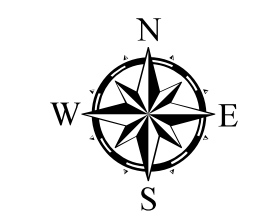

North American Datum
of 1986

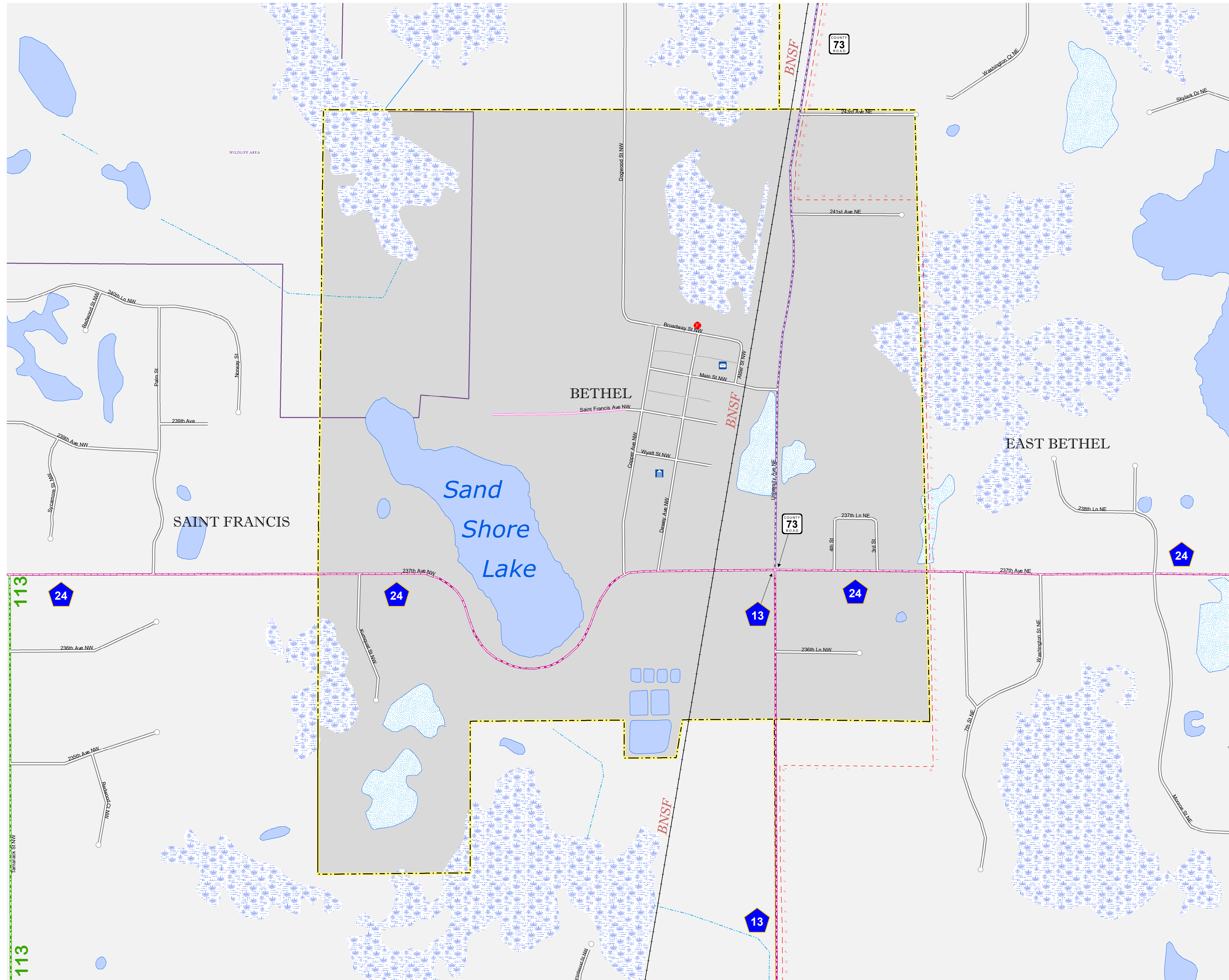

ROAD AND ROADWAY FEATURES	PUBLIC SERVICE FEATURES
INTERSTATE	MINOT OFFICE
US HIGHWAY	MINOT TRUCK STATION
BN HIGHWAY	HIGHWAY PATROL DISTRICT OFFICE
COUNTY STATE AID HIGHWAY	STATE TRAVEL INFORMATION CENTER
COUNTY ROAD	REST AREA (Full Service)
MUNICIPAL STREET	REST AREA (Quick Turn)
MUNICIPAL STATE AID STREET	WAYSIDE (Only on Pkwy/Trk+)
PRIVATE STREET/ROAD	PUBLIC ACCESS POINT
TOWNSHIP ROAD	LOCAL PARK
UNORGANIZED TERRITORY ROAD	FARMS/GROUNDS
RAMP OR CONNECTOR	PORT OF ENTRY
INTERSTATE EXIT	PARK AND RIDE LOT
GREAT RIVER ROAD	PUBLIC UNIVERSITY/COLLEGE
OTHER ROADS	PRIVATE UNIVERSITY/COLLEGE
FARMROAD	ELEMENTARY SCHOOL
INDUS SERVICE	MIDDLE SCHOOL
NATIONAL FOREST	HIGH SCHOOL
MILITARY	
RAILROAD AND RAILWAY FEATURES	AVIATION FEATURES
EMPIRE BUILDER STATION (ARTIK)	COMMERCIAL AIRPORT
NORTHSTAR STATION (COMMERCE)	GENERAL AIRPORT
LIGHT RAIL	AIRSTRIP
BLUE LINE STATION	SEAPLANE
GREEN LINE STATION	AIRPORT RUNWAY
INFRASTRUCTURE FEATURES	CULTURAL FEATURES
LONG BRIDGE (100' OR GREATER SPAN)	STATE HISTORIC MARKER
MAJOR BRIDGE (20' TO 100' SPAN)	HISTORIC DISTRICT
MINOR BRIDGE (2' TO 20' SPAN)	HISTORIC SITE
ROAD TUNNEL (100' OR GREATER SPAN)	MONUMENT
RAILROAD BRIDGE (100' OR GREATER SPAN)	CEMETERY
RAILROAD BRIDGE (LESSER 100' SPAN)	
SKYWAY	
PEDESTRIAN BRIDGE	
PEDESTRIAN TUNNEL	
DAM	
LOCK AND DAM	
PUBLIC FACILITIES	BOUNDARY FEATURES
STATE CAPITOL	MUNICIPALITY
FEDERAL COURTHOUSE	ADJACENT MUNICIPALITY
COUNTY COURTHOUSE	FEDERAL ADJUSTED URBAN AREA (2014)
ARMORY	MILITARY
CITY HALL	STATE PARK
COMMUNITY CENTER	REGIONAL PARK
ARENA	NATIONAL FOREST
STADIUM	NATIONAL AND STATE FOREST
POST OFFICE	STATE FOREST
POLICE STATION	NATIONAL TRAIL
FIRE STATION	WILDLIFE REFUGE AREA
PUBLIC LIBRARY	WILDLIFE MANAGEMENT AREA
PUBLIC MUSEUM	RIVER OR STREAM (PERMANENT)
EVENT CENTER	LAKE, POND OR RESERVOIR
	STREAM (PERMANENT)
	DRAINAGE DITCH
CITY CENTERS	HYDROLOGIC FEATURES
TRIBAL GOVERNMENT CENTER	WETLAND
CITY CENTER	ISLAND OR LAND
LOCALLY KNOWN PLACE	REGIONAL WATERSHED
UNINCORPORATED COMMUNITY	

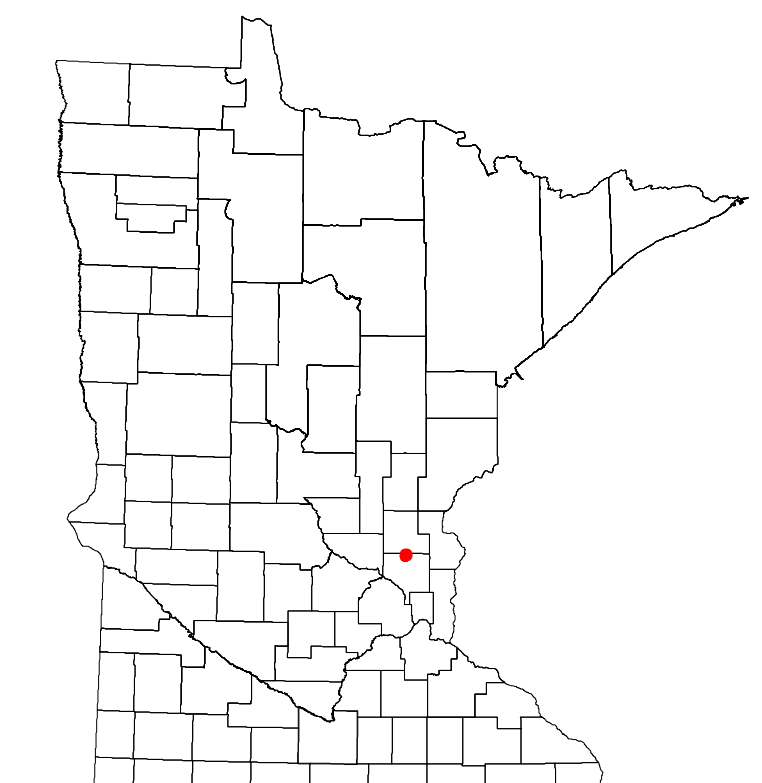

To request information from this document in an alternative format, call 651-366-4718 or 1-800-657-3774 (Greater Minnesota); 711 or 1-800-627-3529 (Minnesota Relay). You may also send an e-mail to ADarequest.dot@state.mn.us. (Please request at least one week in advance.)

LAST EDITED ON 11-19-2024

Population (U.S. Census 2020): 476