

TOWNSHIP OF BEMIDJI

PREPARED BY THE
MINNESOTA DEPARTMENT OF TRANSPORTATION
OFFICE OF TRANSPORTATION SYSTEM MANAGEMENT

IN COOPERATION WITH
U.S. DEPARTMENT OF TRANSPORTATION
FEDERAL HIGHWAY ADMINISTRATION

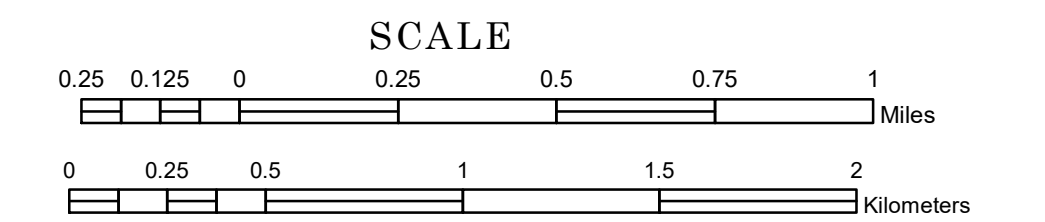

2024

Projection:
Transverse Mercator
NAD 1986
UTM Zone 15

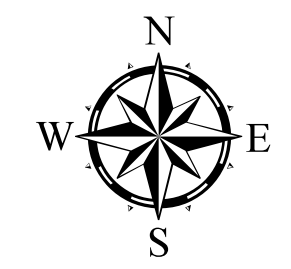

North American Datum
of 1986

ROAD AND ROADWAY FEATURES						
INTERSTATE	CONCRETE					
US HIGHWAY	BITUMINOUS					
MN HIGHWAY	GRAVEL					
COUNTY STATE AID HIGHWAY	DIRT/UNIMPROVED					
COUNTY ROAD	OTHER					
TOWNSHIP ROAD	UNKNOWN					
UNORGANIZED TERRITORY ROAD						
OTHER ROADS	RAMP OR CONNECTOR					
Municipal	Private	National Monument	State Forest	State Game	State Park	Present
Nature Service	National Park	National Wildlife	State Game	State Park	Present	
Mulvan	National Forest	State Park	Present			
RAILROAD AND RAILWAY FEATURES						
EMPIRE BUILDER STATION (AMTRAK)	COMMERCIAL AIRPORT					
NORTHSTAR STATION (COMPUTER)	GENERAL AIRPORT					
	AIRSTRIP					
	SEAPLANE					
	AIRPORT RUNWAY					
	BOUNDARY FEATURES					
	TRIBAL LAND					
	STATE OF MINNESOTA					
	COUNTY					
	MUNICIPALITY					
	UNORGANIZED TERRITORY					
	FEDERAL ADJUSTED URBAN AREA (2014)					
	CIVIL TOWNSHIP					
	CONGRESSIONAL TOWNSHIP					
	SECTION					
	MILITARY					
	VOYAGEURS NATIONAL PARK					
	BOUNDARY WATERS CANOE AREA WILDERNESS					
	STATE PARK					
	NATIONAL FOREST					
	NATIONAL AND STATE FOREST					
	STATE FOREST					
	NATIONAL TRAIL					
	WILDLIFE REFUGE AREA					
	WILDLIFE MANAGEMENT AREA					
	HYDROLOGIC FEATURES					
	RIVER OR STREAM (PERMANENT)					
	LAKE, POND OR RESERVOIR					
	STREAM (INTERMITTENT)					
	DRAINAGE DITCH					
	WETLAND					
	ISLAND OR LAND					
	REGIONAL WATERSHED					
CITY CENTERS						
STATE CAPITAL	COUNTY SEAT	CITY CENTER	UNINCORPORATED COMMUNITY			
PUBLIC SERVICE FEATURES						
MNDOT OFFICE						
MNDOT TRUCK STATION						
HIGHWAY PATROL DISTRICT OFFICE						
STATE TRAVEL INFORMATION CENTER						
REST AREA (Full Service)						
REST AREA (Vault Toilet)						
WAYSIDE (Vault or Pit Toilet)						
PARK AND RIDE LOT						
PORT OF ENTRY						
PUBLIC ACCESS POINT						
MN STATE COLLEGE AND UNIVERSITY SYSTEM (MNSCU)						
UNIVERSITY OF MN SYSTEM						
FARMS						
CULTURAL FEATURES						
STATE HISTORICAL MARKER						
HISTORIC DISTRICT						
HISTORIC SITE						
MONUMENT						



Population (U.S. Census 2010): 3134

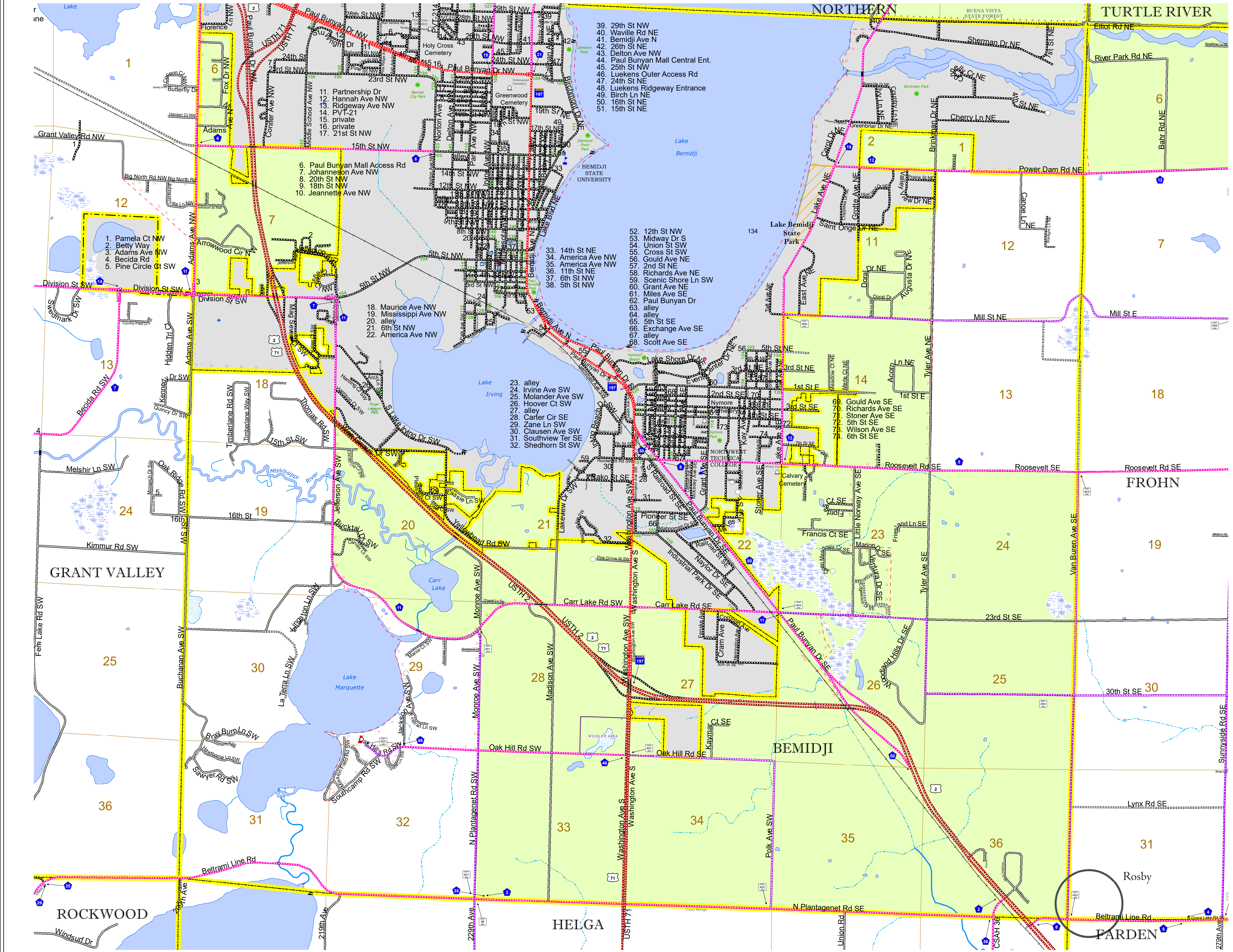

To request information from this document in an alternative format, call 651-366-4718 or 1-800-657-3774 (Greater Minnesota); 711 or 1-800-627-3529 (Minnesota Relay). You may also send an e-mail to ADArequest.dot@state.mn.us. (Please request at least one week in advance.)