

# TOWNSHIP OF WRENSHALL

PREPARED BY THE  
MINNESOTA DEPARTMENT OF TRANSPORTATION  
OFFICE OF TRANSPORTATION SYSTEM MANAGEMENT

IN COOPERATION WITH  
U.S. DEPARTMENT OF TRANSPORTATION  
FEDERAL HIGHWAY ADMINISTRATION

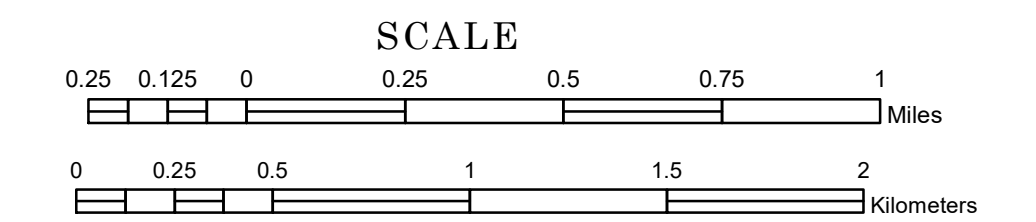

1 in = 1,600 ft

2024

Projection:  
Transverse Mercator  
NAD 1986  
UTM Zone 15

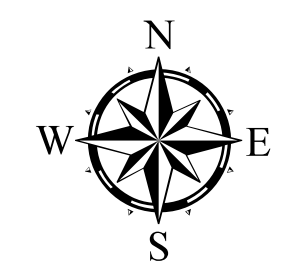

North American Datum  
of 1986

ROAD AND ROADWAY FEATURES		AVIATION FEATURES	
INTERSTATE	CONCRETE	COMMERCIAL AIRPORT	GENERAL AIRPORT
US HIGHWAY	BITUMINOUS	AIRSTRIP	AIRSTRIP
MN HIGHWAY	GRAVEL	SEAPLANE	SEAPLANE
COUNTY STATE AID HIGHWAY	DIRT/UNIMPROVED	AIRPORT RUNWAY	AIRPORT RUNWAY
COUNTY ROAD	OTHER	BOUNDARY FEATURES	BOUNDARY FEATURES
TOWNSHIP ROAD	UNKNOWN	TRIBAL LAND	TRIBAL LAND
UNORGANIZED TERRITORY ROAD	RAMP OR CONNECTOR	STATE OF MINNESOTA	STATE OF MINNESOTA
OTHER ROADS	INTERSTATE EXIT	COUNTY	COUNTY
Municipal	GREAT RIVER ROAD	MUNICIPALITY	MUNICIPALITY
Private	RAILROAD AND RAILWAY FEATURES	UNORGANIZED TERRITORY	UNORGANIZED TERRITORY
National Monument	EMPIRE BUILDER STATION (AMTRAK)	FEDERAL ADJUSTED URBAN AREA (2014)	FEDERAL ADJUSTED URBAN AREA (2014)
National Wildlife Refuge	NORTHSTAR STATION (COMMUTER)	CIVIL TOWNSHIP	CIVIL TOWNSHIP
State Game	LIGHT RAIL	CONGRESSIONAL TOWNSHIP	CONGRESSIONAL TOWNSHIP
State Park	BLUE LINE	SECTION	SECTION
Present	GREEN LINE	MILITARY	MILITARY
INFRASTRUCTURE FEATURES	LONG BRIDGE (200' or Greater Span)	MNDOT OFFICE	MNDOT OFFICE
TRIAL	MAJOR BRIDGE (20' to 200' Span)	HIGHWAY PATROL STATION	HIGHWAY PATROL STATION
STATE OF MINNESOTA	MINOR BRIDGE (5' to 20' Span)	STATE TRAVEL INFORMATION CENTER	STATE TRAVEL INFORMATION CENTER
COUNTY	DAM	REST AREA (Full Service)	REST AREA (Full Service)
MUNICIPALITY	LOCK AND DAM	REST AREA (Vault Toilet)	REST AREA (Vault Toilet)
UNORGANIZED TERRITORY	CITY CENTERS	WAYSIDE (Vault or Pit Toilet)	WAYSIDE (Vault or Pit Toilet)
FEDERAL ADJUSTED URBAN AREA (2014)	STATE CAPITAL	PARK AND RIDE LOT	PARK AND RIDE LOT
CIVIL TOWNSHIP	COUNTY SEAT	PORT OF ENTRY	PORT OF ENTRY
CONGRESSIONAL TOWNSHIP	CITY CENTER	PUBLIC ACCESS POINT	PUBLIC ACCESS POINT
SECTION	UNINCORPORATED COMMUNITY	MN STATE COLLEGE AND UNIVERSITY SYSTEM (MNSCU)	MN STATE COLLEGE AND UNIVERSITY SYSTEM (MNSCU)
MILITARY	PUBLIC SERVICE FEATURES	UNIVERSITY OF MN SYSTEM	UNIVERSITY OF MN SYSTEM
VOYAGEURS NATIONAL PARK	MNDOT OFFICE	FARSGROUNDS	FARSGROUNDS
BOUNDARY WATERS CANOE AREA WILDERNESS	HIGHWAY PATROL STATION	CULTURAL FEATURES	CULTURAL FEATURES
STATE PARK	STATE TRAVEL INFORMATION CENTER	STATE HISTORICAL MARKER	STATE HISTORICAL MARKER
NATIONAL FOREST	REST AREA (Full Service)	HISTORIC DISTRICT	HISTORIC DISTRICT
NATIONAL AND STATE FOREST	REST AREA (Vault Toilet)	HISTORIC SITE	HISTORIC SITE
STATE FOREST	WAYSIDE (Vault or Pit Toilet)	MONUMENT	MONUMENT
NATIONAL TRAIL	PARK AND RIDE LOT	REGIONAL WATERSHED	REGIONAL WATERSHED
WILDLIFE REFUGE AREA	PORT OF ENTRY		
WILDLIFE MANAGEMENT AREA	PUBLIC ACCESS POINT		
HYDROLOGIC FEATURES	MN STATE COLLEGE AND UNIVERSITY SYSTEM (MNSCU)		
RIVER OR STREAM (Perennial)	UNIVERSITY OF MN SYSTEM		
LAKE, POND OR RESERVOIR	FARSGROUNDS		
STREAM (Intermittent)	CULTURAL FEATURES		
DRAINAGE DITCH	STATE HISTORICAL MARKER		
WETLAND	HISTORIC DISTRICT		
ISLAND OR LAND	HISTORIC SITE		
	MONUMENT		

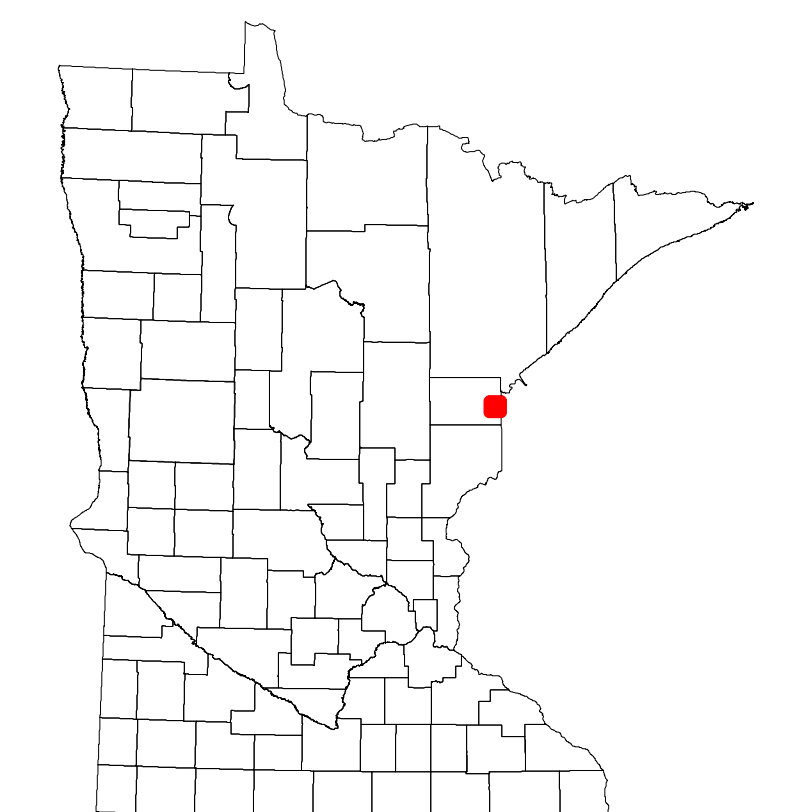

Population (U.S. Census 2010): 382

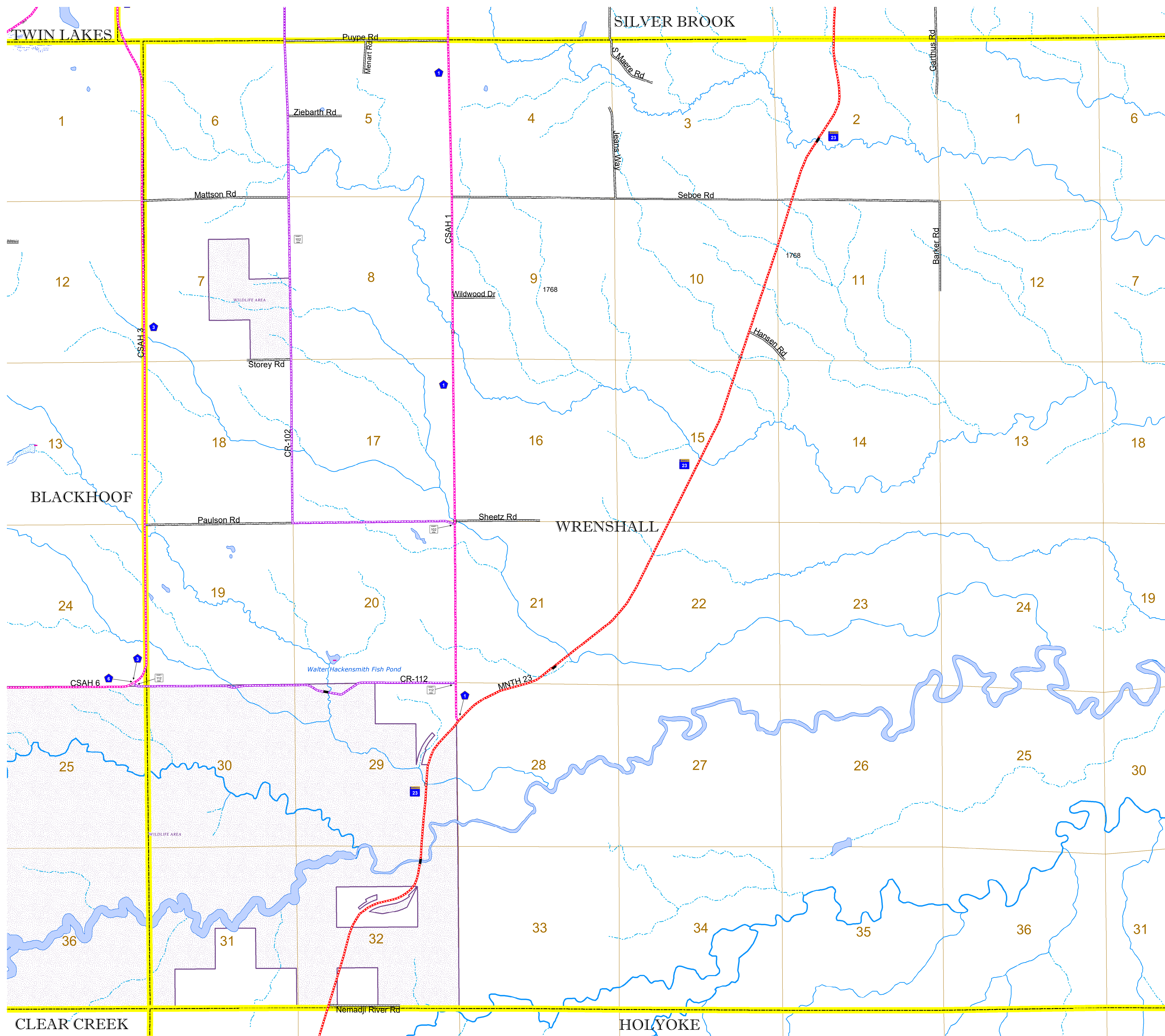

To request information from this document in an alternative format, call 651-366-4718 or 1-800-657-3774 (Greater Minnesota); 711 or 1-800-627-3529 (Minnesota Relay). You may also send an e-mail to [ADArequest.dot@state.mn.us](mailto:ADArequest.dot@state.mn.us). (Please request at least one week in advance.)