

TOWNSHIP OF NORWAY

PREPARED BY THE
MINNESOTA DEPARTMENT OF TRANSPORTATION
OFFICE OF TRANSPORTATION SYSTEM MANAGEMENT

IN COOPERATION WITH
U.S. DEPARTMENT OF TRANSPORTATION
FEDERAL HIGHWAY ADMINISTRATION

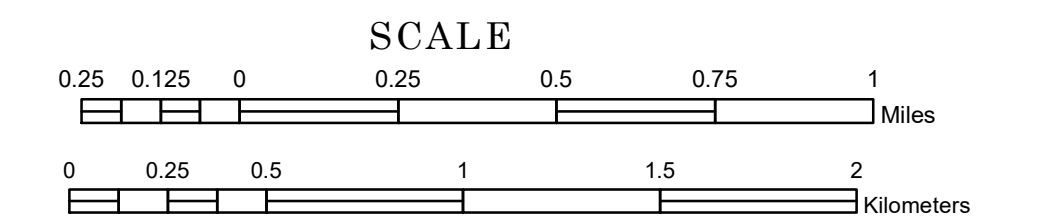

Projection:
Transverse Mercator
NAD 1986
UTM Zone 15

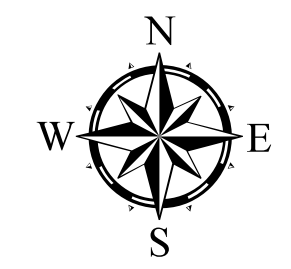

North American Datum
of 1986

| ROAD AND ROADWAY FEATURES | | AVIATION FEATURES | |
|------------------------------------|---------------------------------------|------------------------------------|--|
| INTERSTATE | CONCRETE | COMMERCIAL AIRPORT | GENERAL AIRPORT |
| US HIGHWAY | BITUMINOUS | AIRSTRIP | SEAPLANE |
| MN HIGHWAY | GRAVEL | AIRPORT RUNWAY | RAILROAD AND RAILWAY FEATURES |
| COUNTY STATE AID HIGHWAY | DIRT/UNIMPROVED | EMPIRE BUILDER STATION (AMTRAK) | NORTHSTAR STATION (COMPUTER) |
| COUNTY ROAD | OTHER | LIGHT RAIL | BLUE LINE |
| TOWNSHIP ROAD | UNKNOWN | GREEN LINE | INFRASTRUCTURE FEATURES |
| UNORGANIZED TERRITORY ROAD | RAMP OR CONNECTOR | LONG BRIDGE (200' OR GREATER SPAN) | MAJOR BRIDGE (20' TO 200' SPAN) |
| OTHER ROADS | INTERSTATE EXIT | MINOR BRIDGE (5' TO 20' SPAN) | DAM |
| Municipal | RAILROAD AND RAILWAY FEATURES | LOCK AND DAM | CITY CENTERS |
| Private | COMMERCIAL AIRPORT | STATE CAPITAL | COUNTY SEAT |
| National Monument | GENERAL AIRPORT | CITY CENTER | UNINCORPORATED COMMUNITY |
| National Wildlife Refuge | AIRSTRIP | PUBLIC SERVICE FEATURES | MNDOT OFFICE |
| State Park | SEAPLANE | MNDOT TRUCK STATION | HIGHWAY PATROL DISTRICT OFFICE |
| Preserve | AIRPORT RUNWAY | STATE TRAVEL INFORMATION CENTER | REST AREA (FULL SERVICE) |
| BOUNDARY FEATURES | TRIBAL LAND | REST AREA (VAULT TOILET) | WAYSIDE (VAULT OR PITY TOILET) |
| STATE OF MINNESOTA | COUNTY | PARK AND RIDE LOT | PORT OF ENTRY |
| MUNICIPALITY | UNORGANIZED TERRITORY | PUBLIC ACCESS POINT | MN STATE COLLEGE AND UNIVERSITY SYSTEM (MNSCU) |
| FEDERAL ADJUSTED URBAN AREA (2014) | CIVIL TOWNSHIP | UNIVERSITY OF MN SYSTEM | FAIRGROUNDS |
| CIVIL TOWNSHIP | CONGRESSIONAL TOWNSHIP | CULTURAL FEATURES | STATE HISTORICAL MARKER |
| SECTION | MILITARY | HISTORIC DISTRICT | HISTORIC SITE |
| VOYAGEURS NATIONAL PARK | BOUNDARY WATERS CANOE AREA WILDERNESS | HISTORIC SITE | MONUMENT |
| STATE PARK | REGIONAL PARK | HYDROLOGIC FEATURES | |
| NATIONAL FOREST | NATIONAL AND STATE FOREST | WILDLIFE REFUGES | |
| STATE FOREST | WILDLIFE REFUGES | WILDLIFE MANAGEMENT AREA | |
| WILDLIFE REFUGES | WILDLIFE MANAGEMENT AREA | HYDROLOGIC FEATURES | |
| WILDLIFE MANAGEMENT AREA | HYDROLOGIC FEATURES | RIVER OR STREAM (PERMANENT) | |
| RIVER OR STREAM (PERMANENT) | LAKE, POND OR RESERVOIR | STREAM (INTERMITTENT) | |
| LAKE, POND OR RESERVOIR | STREAM (INTERMITTENT) | DRAINAGE DITCH | |
| STREAM (INTERMITTENT) | DRAINAGE DITCH | WETLAND | |
| DRAINAGE DITCH | WETLAND | ISLAND OR LAND | |
| WETLAND | ISLAND OR LAND | REGIONAL WATERSHED | |
| ISLAND OR LAND | REGIONAL WATERSHED | | |

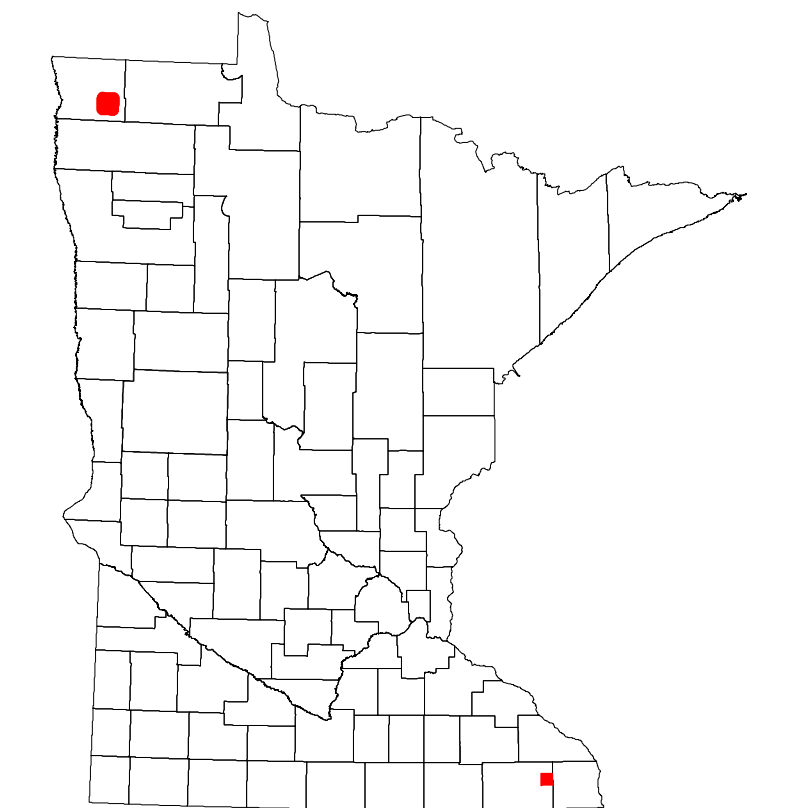

Population (U.S. Census 2010): 91

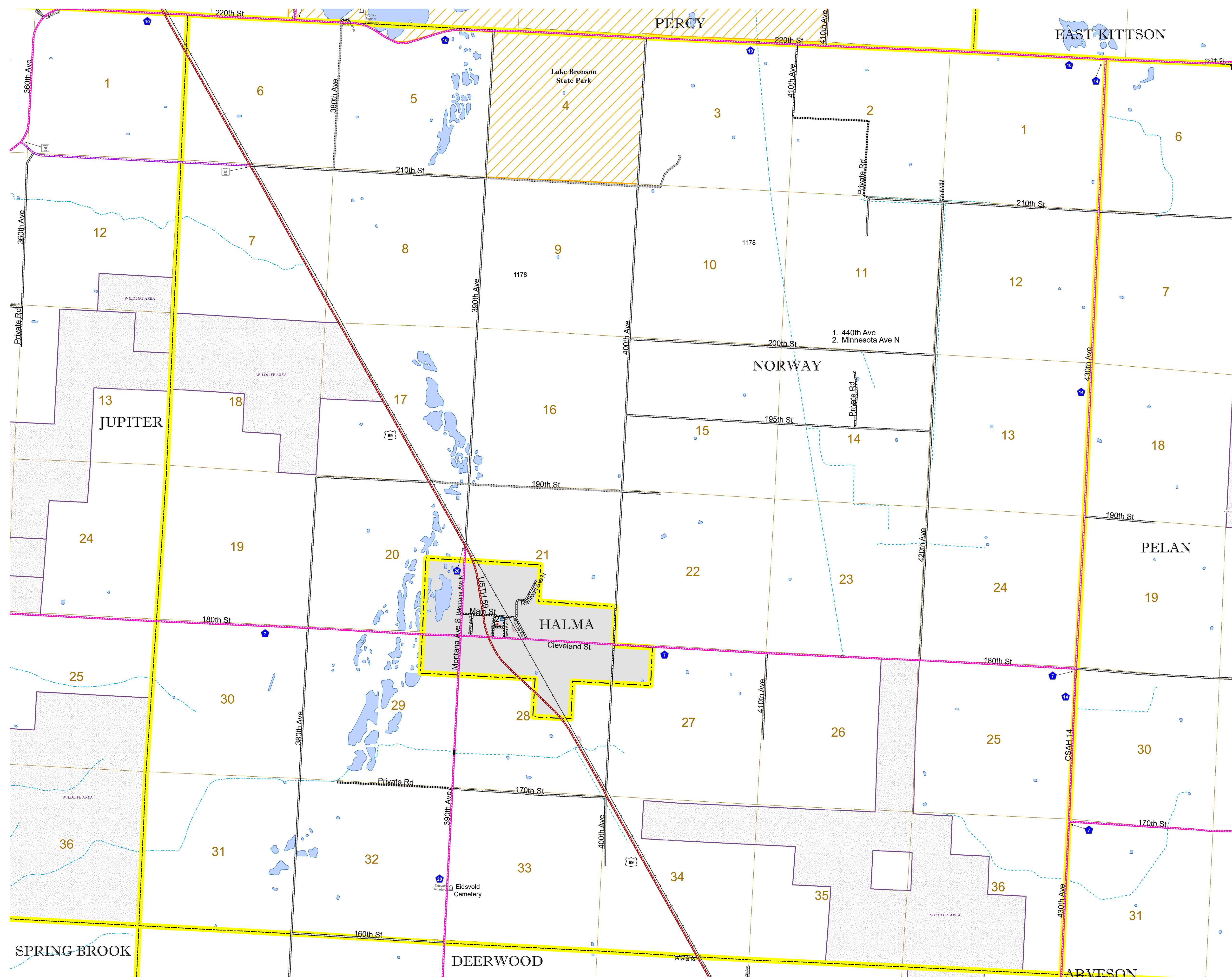

To request information from this document in an alternative format, call 651-366-4718 or 1-800-657-3774 (Greater Minnesota); 711 or 1-800-627-3529 (Minnesota Relay). You may also send an e-mail to ADRequest.dot@state.mn.us. (Please request at least one week in advance.)