

TOWNSHIP OF PROVIDENCE

PREPARED BY THE
MINNESOTA DEPARTMENT OF TRANSPORTATION
OFFICE OF TRANSPORTATION SYSTEM MANAGEMENT

IN COOPERATION WITH
U.S. DEPARTMENT OF TRANSPORTATION
FEDERAL HIGHWAY ADMINISTRATION

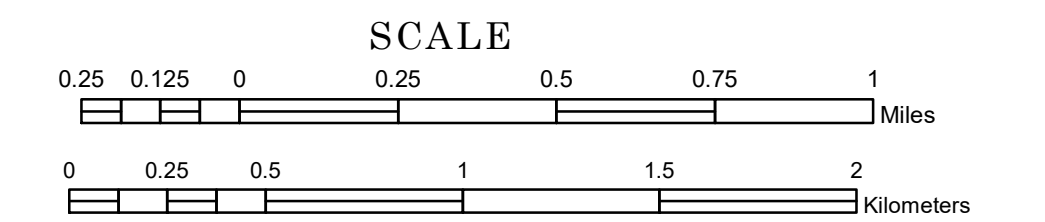

2024

Projection:
Transverse Mercator
NAD 1986
UTM Zone 15

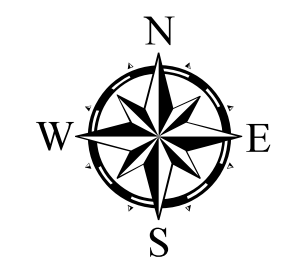

North American Datum
of 1986

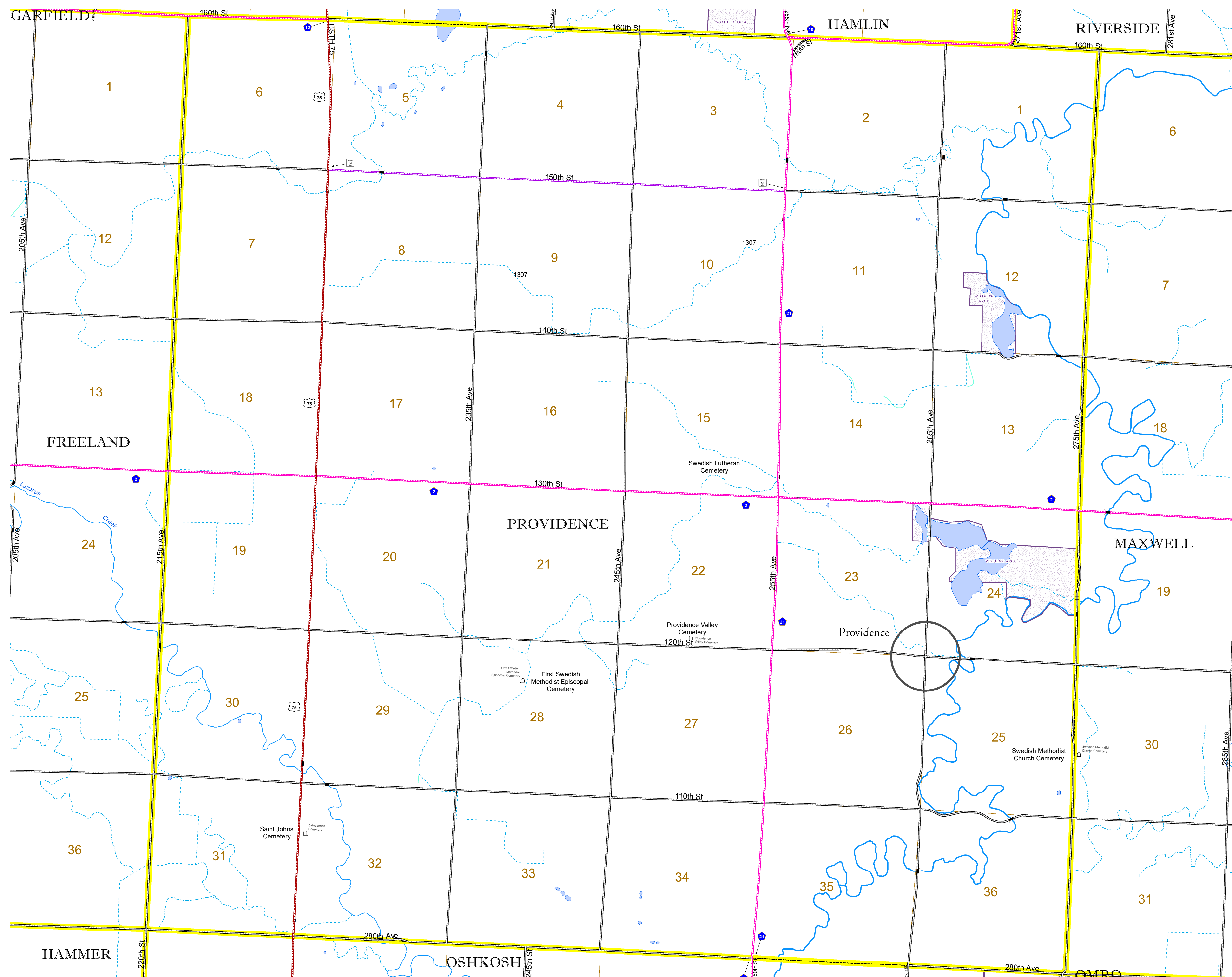

ROAD AND ROADWAY FEATURES		BOUNDARY FEATURES	
INTERSTATE	CONCRETE	TRIBAL LAND	STATE OF MINNESOTA
US HIGHWAY	BITUMINOUS	COUNTY	MUNICIPALITY
MN HIGHWAY	GRAVEL	UNINCORPORATED TOWNSHIP	CIVIL TOWNSHIP
COUNTY STATE AID HIGHWAY	DIRT/UNIMPROVED	FEDERAL ADJUSTED URBAN AREA (2014)	CONGRESSIONAL TOWNSHIP
COUNTY ROAD	OTHER	CIVIL TOWNSHIP	SECTION
TOWNSHIP ROAD	UNKNOWN	MILITARY	VOYAGEURS NATIONAL PARK
UNORGANIZED TERRITORY ROAD	UNKNOWN	BOUNDARY WATERS CANOE AREA WILDERNESS	STATE PARK
OTHER ROADS			NATIONAL FOREST
Municipal	RAMP OR CONNECTOR		NATIONAL AND STATE FOREST
Private	INTERSTATE EXIT		STATE FOREST
Nature Service	GREAT RIVER ROAD		NATIONAL TRAIL
Mulvan			WILDLIFE REFUGUE AREA
			WILDLIFE MANAGEMENT AREA
			HYDROLOGIC FEATURES
			RIVER OR STREAM (PERENNIAL)
			LAKE, POND OR RESERVOIR
			STREAM (INTERMITTENT)
			DRAINAGE DITCH
			WETLAND
			ISLAND OR LAND
			REGIONAL WATERSHED

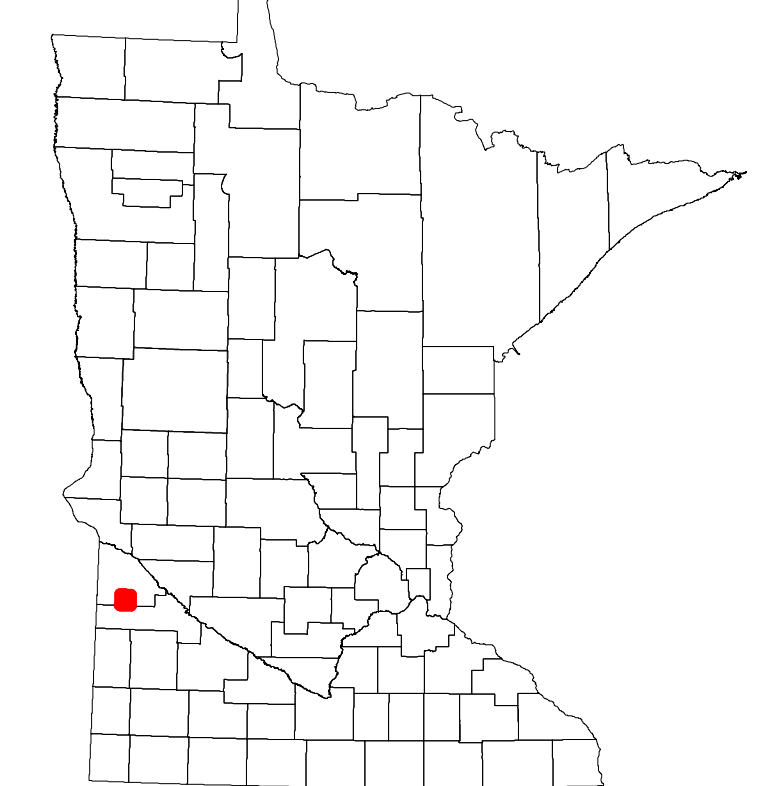

Population (U.S. Census 2010): 169

To request information from this document in an alternative format, call 651-366-4718 or 1-800-657-3774 (Greater Minnesota); 711 or 1-800-627-3529 (Minnesota Relay). You may also send an e-mail to ADArequest.dot@state.mn.us. (Please request at least one week in advance.)