

TOWNSHIP OF WATERBURY

PREPARED BY THE
MINNESOTA DEPARTMENT OF TRANSPORTATION
OFFICE OF TRANSPORTATION SYSTEM MANAGEMENT

IN COOPERATION WITH
U.S. DEPARTMENT OF TRANSPORTATION
FEDERAL HIGHWAY ADMINISTRATION

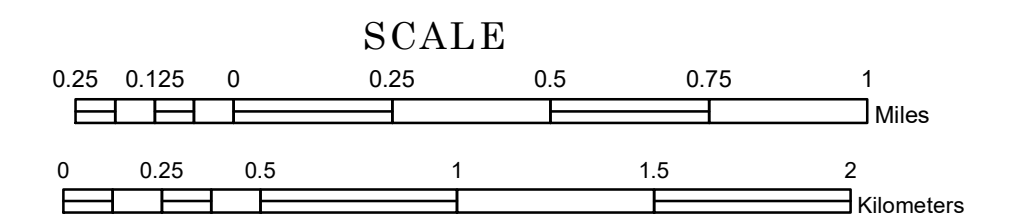

1 in = 1,600 ft

2023

Projection:
Transverse Mercator
NAD 1986
UTM Zone 15



North American Datum
of 1986

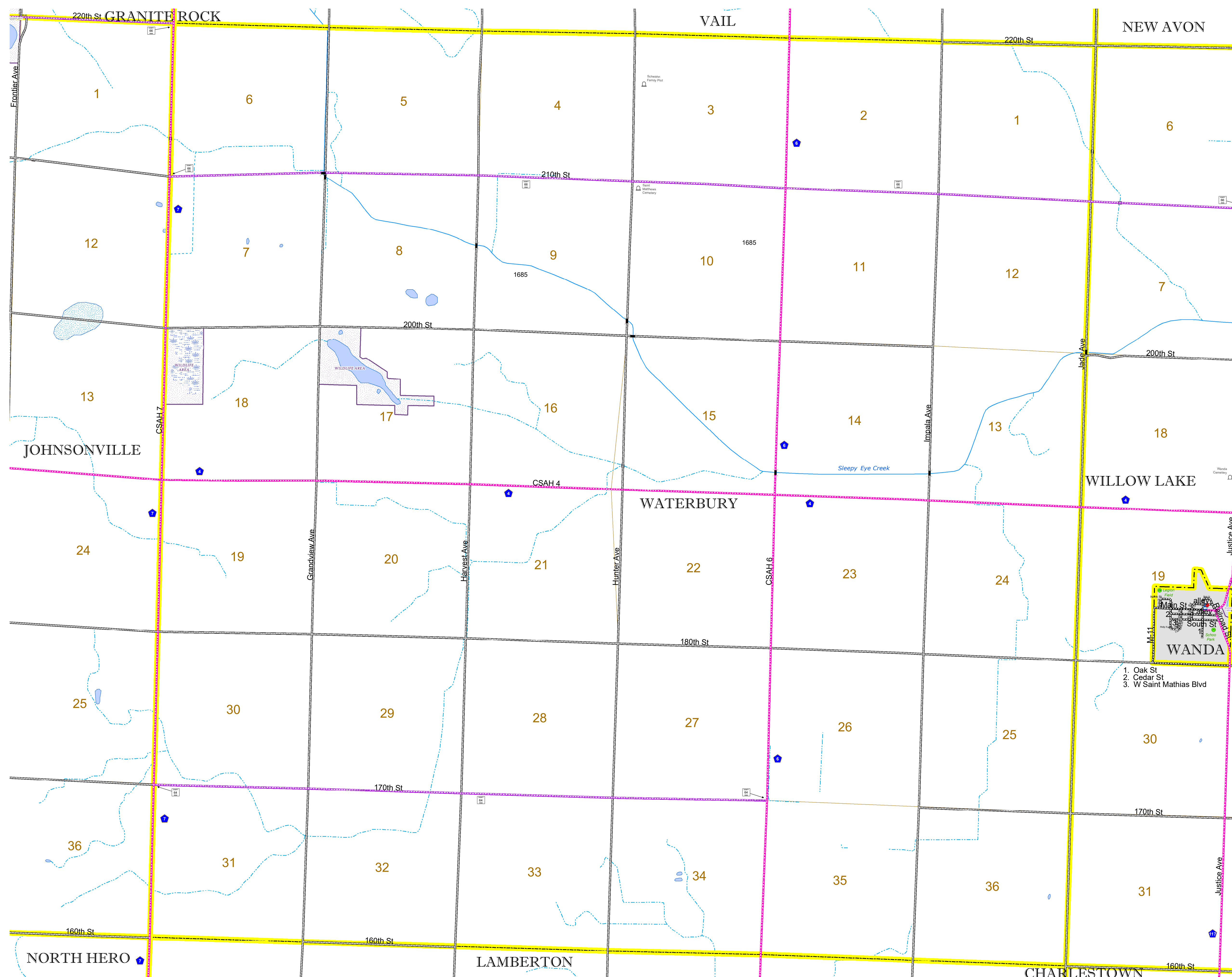

ROAD AND ROADWAY FEATURES		AVIATION FEATURES	
INTERSTATE	CONCRETE	COMMERCIAL AIRPORT	GENERAL AIRPORT
US HIGHWAY	BITUMINOUS	NORTHSTAR STATION (COMPUTER)	AIRSTRIP
MN HIGHWAY	GRAVEL	LIGHT RAIL	SEAPLANE
COUNTY STATE AID HIGHWAY	DIRT/UNIMPROVED	BLUE LINE	AIRPORT RUNWAY
COUNTY ROAD	OTHER	GREEN LINE	
TOWNSHIP ROAD	UNKNOWN	INFRASTRUCTURE FEATURES	
UNORGANIZED TERRITORY ROAD		LONG BRIDGE (200' OR GREATER SPAN)	TRIBAL LAND
OTHER ROADS		MAJOR BRIDGE (20' TO 200' SPAN)	STATE OF MINNESOTA
MUNICIPAL		MINOR BRIDGE (5' TO 20' SPAN)	COUNTY
PRIVATE		LOCK AND DAM	MUNICIPALITY
NATIONAL MONUMENT			UNORGANIZED TERRITORY
NATIONAL WILDLIFE REFUGUE			FEDERAL ADJUSTED URBAN AREA (2014)
STATE FOREST			CIVIL TOWNSHIP
STATE PARK			CONGRESSIONAL TOWNSHIP
STATE TRAIL			SECTION
WILDLIFE REFUGE AREA			MILITARY
WILDLIFE MANAGEMENT AREA			VOYAGEURS NATIONAL PARK
RIVER OR STREAM (PERMANENT)			BOUNDARY WATERS CANOE AREA WILDERNESS
LAKE, POND OR RESERVOIR			STATE PARK
STREAM (INTERMITTENT)			REGIONAL PARK
DRAINAGE DITCH			NATIONAL FOREST
WETLAND			NATIONAL AND STATE FOREST
ISLAND OR LAND			STATE FOREST
REGIONAL WATERSHED			WILDLIFE REFUGE AREA
			WILDLIFE MANAGEMENT AREA
			HYDROLOGIC FEATURES
			RIVER OR STREAM (PERMANENT)
			LAKE, POND OR RESERVOIR
			STREAM (INTERMITTENT)
			DRAINAGE DITCH
			WETLAND
			ISLAND OR LAND
			REGIONAL WATERSHED

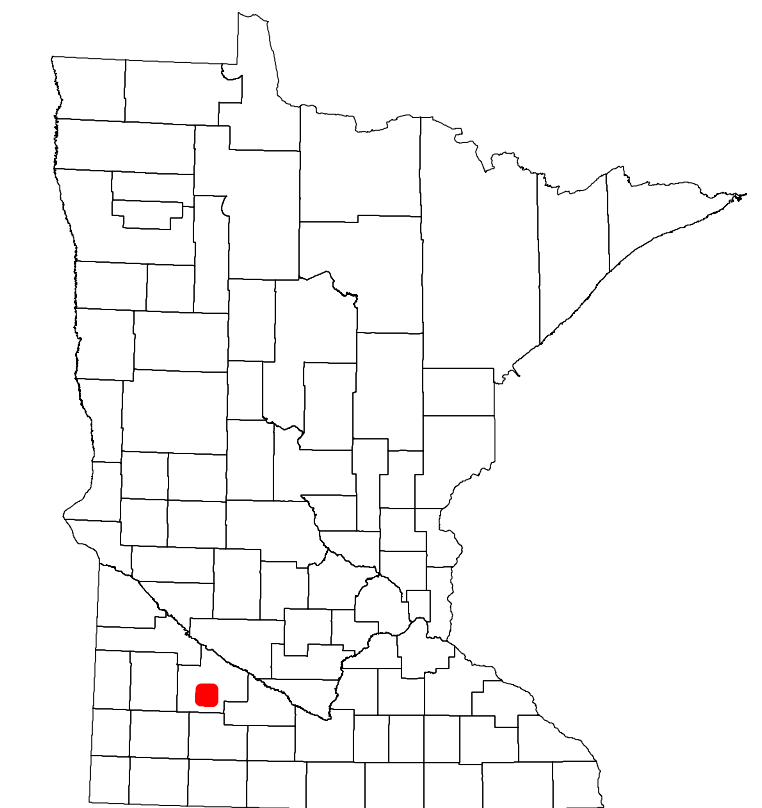
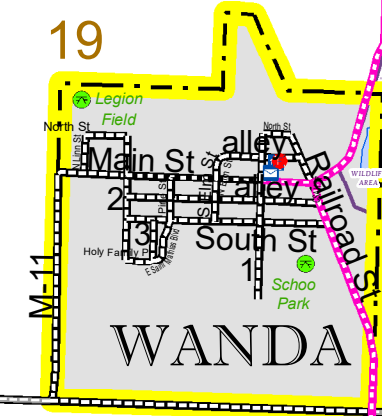

Population (U.S. Census 2010): 196

To request information from this document in an alternative format, call 651-366-4718 or 1-800-657-3774 (Greater Minnesota); 711 or 1-800-627-3529 (Minnesota Relay). You may also send an e-mail to ADarequest.dot@state.mn.us. (Please request at least one week in advance.)