

PREPARED BY
 TRANSPORTATION & TRANSIT PLANNING & PROGRAMMING DIVISION
 IN COOPERATION WITH
 U.S. DEPARTMENT OF TRANSPORTATION-BUREAU OF PUBLIC ROADS

STATE OF MINNESOTA
 DEPARTMENT OF HIGHWAYS
 ROAD LIFE STUDIES
 CONSTRUCTION PROJECT LOG RECORD

CONTROL SECTION 0282
 TRUNK HIGHWAY 35E
 COUNTY Anoka
 DISTRICT Metro

LIMITS: Ramsey - Anoka Co. Line - N. Jct. TH. 35 & 35 W
 Ref. Pt. 120+00.382 - 127+00.420

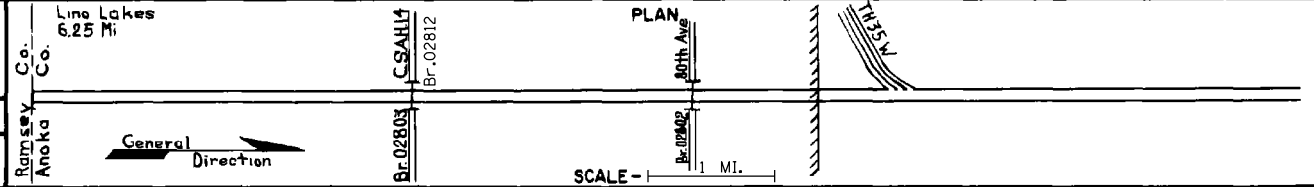

YEAR BUILT	PROJECT NO	DESCRIPTION	WIDTH	THICKNESS	REMARKS
C	6281-03	Grading			Divided Highway
1970	6281-04	Gravel Base P.C. Concrete	2@24'	6"	PI Mix Bit Shoulder
C	1970 0282-06	Grading Br. 02802 Br. 02803			Divided Highway 210' P.P.G.-UP. 209' B.S.-UP.
C	1970 0282-09	Gravel Base P.C. Concrete PI Mix Bit Shoulders	2@24'	6"	
C	0283-03	Grading			Divided Highway
1970	0283-07	Gravel Base P.C. Concrete	2@24'	5"	
C	1971 0282-14	Lighting			CSAH14
C	1994 0282-24	Bit. Overlay Br. 02802, Br. 02803	24'	1"-1/2"	61WEA75100X-Spec. 2340 61BIB75100X-Spec. 2340
M	1995 0282-95036	Major Crack Repair			
M	2001 8825-102	Rout & Seal			Spec. 3725
S	2011 0282-34	Grading Bit. Mill & Surfacing Conc. Overlay	24'	2"	Unbonded
	2013 0282-36	Transverse Grooves			RT Lane
	2016 0282-39 (6282-47)	Grading/ Agg. base Bit. Surfacing Conc. Surfacing	var. var. var.	var. 7" 9"	Class 6 Spec. 2360

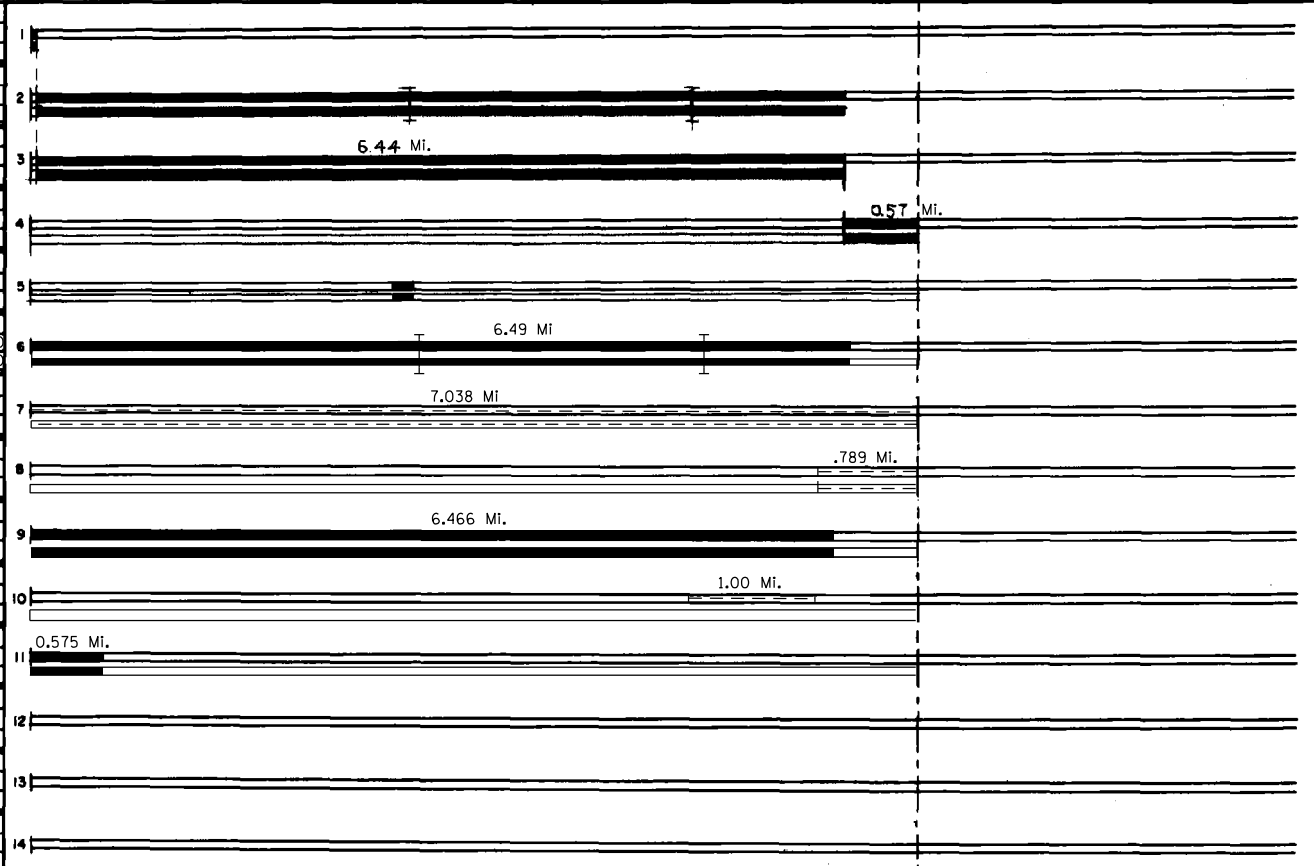

YEARS		TOTAL MILES	UNINCORPORATED		INCORPORATED		RURAL		URBAN	
FROM	TO		RDWY. MI.	BR. MI.	RDWY. MI.	BR. MI.	RDWY. MI.	BR. MI.	RDWY. MI.	BR. MI.
1970		7.04	0.79	0.00	6.25	0.00	0.79	0.00	6.25	0.00

REMARKS: Layout is to scale as of 1970