

PREPARED BY
HIGHWAY PLANNING SURVEY
IN COOPERATION WITH
U. S. PUBLIC ROADS ADMINISTRATION

STATE OF MINNESOTA
DEPARTMENT OF HIGHWAYS
ROAD LIFE STUDIES
CONSTRUCTION PROJECT LOG RECORD

CONTROL SECTION 0415
TRUNK HIGHWAY 35
COUNTY Beltrami
DISTRICT 2A

LIMITS: North Jct. T.H. 1 - West Co. Line

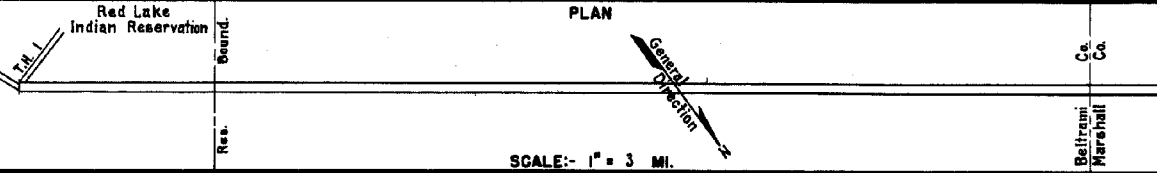

YEAR BUILT	PROJECT N°	DESCRIPTION			CODE N° DIST.
		TYPE	WIDTH	THICKNESS	
		Gravel	24'	2"	No Record of Constr.
		Grading	24'	2"	Added in 1934.
1927		Gravel	24'	2"	Co. Job N° 2706.
		Regrading	30'		Added in 1934.
1938	A.F.E. 28	Gravel	24'	1 1/4"	Maint. Dept.
M		Regraveling			484 C.Y./Mi. Maint. Dept.
1940	1940 A.F.E. 33				
M		Spot Graveling	20'		137 C.Y./Mi. Maint. Dept.
1941	A.F.E. 31				
M		Grav. Resurfacing			492 C.Y./Mi. Maint. Div.
1945	A.F.E. 6				
M		Gravel Resurfacing			2498 Tons
1950	A.F.E. 6				
F		Grading	28'		
1950	0415-02	Gravel	24'		700 C.Y./Mi. 250
C		Heavy Reshaping	28'		
1951	1950 A.F.E. 22	Gravel	24'		9279 C.Y. 3451
C		Grading	38'		
1954	0415-05	Gravel	24'	2 1/2"	1200 C.Y./Mi. 153
M		Shaping & Compacting Sub-base			
1955	A.F.E. B24				
C		Select Granular Mat'l	30'	9"	
1956	0415-07	Gravel Base	30'	3"	556
M		Sand-Grav. Sub-base	28'	6"	5C-3 & MC-1 @ 1300 Gal.
1958	A.F.E. B22	Gravel Base	28'	3"	Agg. 5478 Tons
		Mixed Bit	24'	1"	
C		Grav. Base (M.P. 13.02-17.8)	27'	3"	Bit Stab. Base (M.P. 740-802)
1959	A.F.E. B21	Road Mix Bit. (04) Mi.	24'	1"	5C-3 @ 1797 Gal.
	A.F.E. B26	Grading & Gravel	24'		* 0.64 Mi.

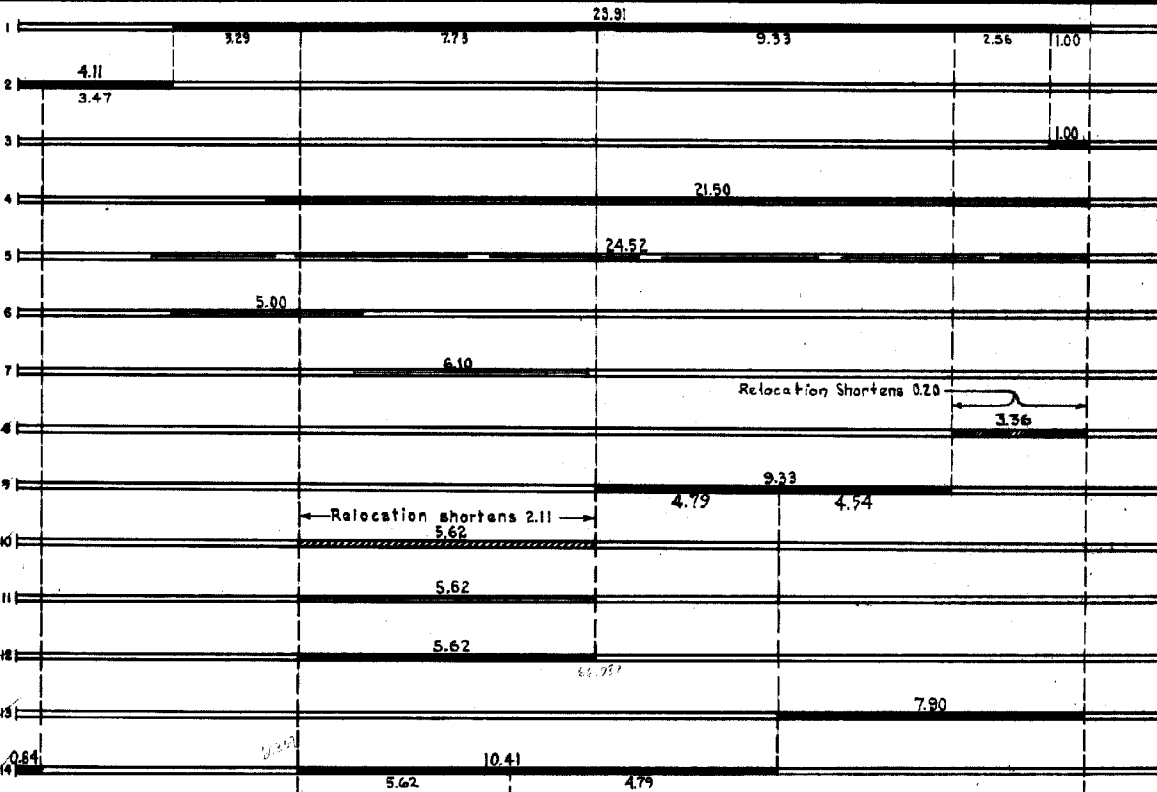

FROM	TO	TOTAL MILES	UNINCORPORATED			INCORPORATED			RURAL				URBAN			
			RDWY. MI.	BR. MI.	0.00	RDWY. MI.	BR. MI.	0.00	RDWY. MI.	BR. MI.	RDWY. MI.	BR. MI.	RDWY. MI.	BR. MI.		
1934	1949	15.02	25.02	0.00	0.00	0.00	28.02	0.00	0.00	0.00	0.00					
1950	1953	27.82	21.82	0.00	0.00	0.00	27.82	0.00	0.00	0.00	0.00					
1954		25.71	25.71	0.00	0.00	0.00	25.71	0.00	0.00	0.00	0.00					

REMARKS: Layout is to scale as of 1934
(1) Contract not final but work substantially complete in 1950.

PREPARED BY
TRAFFIC AND PLANNING DIVISION
IN COOPERATION WITH
U.S. DEPARTMENT OF COMMERCE
BUREAU OF PUBLIC ROADS

STATE OF MINNESOTA
DEPARTMENT OF HIGHWAYS
ROAD LIFE STUDIES
CONSTRUCTION PROJECT LOG RECORD

CONTROL SECTION 0415
TRUNK HIGHWAY 89
COUNTY Beltrami
DISTRICT 2A

LIMITS: N.Jct.T.H.1 - W.Co.Line

Ref. Pt. 053+00.975 - 079+00.680

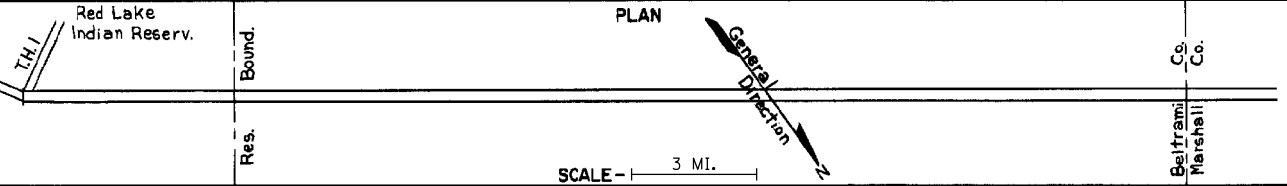

YEAR BUILT	PROJECT NO.	DESCRIPTION	WIDTH	THICKNESS	REMARKS
C 1960		Grading Bit. Stabilized Base	30' 25'	2"	By Maint. Dist.
M 1961		Light Bit. Seal	25'-26'		RS-2, 45637 Gal. Agg. 1600 C.Y.
M 1966	SF	Bit. Surf. Repair	20'		MC-250, 84430 Gal. Agg. 6839 C.Y.
M 1967	C	Light Bit. Seal	25'		RC-250 Bit. 45,025 Gal. FA-1 Agg. 1,578 Ton
M 1970	SF	Pl. Mix Bit.	24'	1 1/4"	NC-800 71,286 Gal. Agg. 7,247 tons
C 1977	0415-09	Pl. Mix Bit. Agg. Shoulders	24' 34'	3"	
C 1983	0415-10	Bituminous Overlay B Agg. Shoulders	24' 4'	1 1/2"	11,088 Ton 12,514 Ton
C 1998	0415-13	Bit. Overlay Gravel shoulders	24' 3'	1"	
S 2001	0415-12	Remove Bituminous Bituminous Layer	24' 24'	9" 4"	Spec. 2350
S 2004	0415-16	Bit. Overlay Aggregate Shoulders	24'	1.5"	Spec. 2360
S 2006	0418-18	Bit. Overlay Aggregate Shoulders	24'	1.5"	Spec. 2360 Class 1
S 2007	0415-15	Widening Bit. Overlay Aggregate Shoulders	28'	1 1/2"	Spec. 2360 Class 1
S 2011	0415-19	Milling Bit. Overlay	24' 24'	1" 2"	Spec. 2360
2013	8822-151	Micro-milling Bit. Seal Coat	24' 24'	.37"	Spec. 2232 Type F2

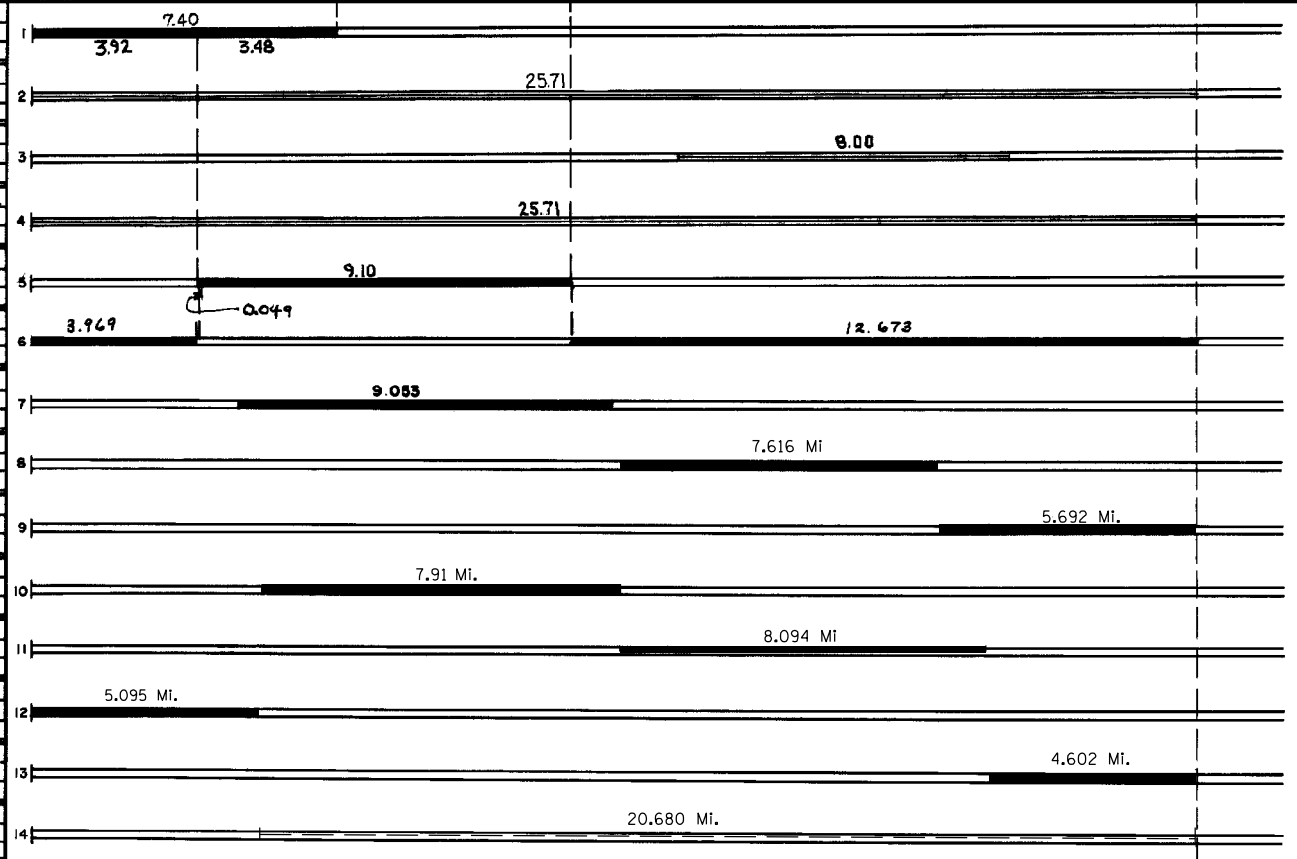

YEARS		TOTAL	UNINCORPORATED		INCORPORATED		RURAL		URBAN	
FROM	TO	MILES	RDWY. MI.	BR. MI.	RDWY. MI.	BR. MI.	RDWY. MI.	BR. MI.	RDWY. MI.	BR. MI.

REMARKS: See Sheet 1
For Other Projects See Dist. No. 681