

PREPARED BY  
HIGHWAY PLANNING SURVEY  
IN COOPERATION WITH  
U.S. PUBLIC ROADS ADMINISTRATION

STATE OF MINNESOTA  
DEPARTMENT OF HIGHWAYS  
ROAD LIFE STUDIES  
CONSTRUCTION PROJECT LOG RECORD

CONTROL SECTION 2501  
TRUNK HIGHWAY 19  
COUNTY Goodhue  
DISTRICT 6B

LIMITS: W. Co. Line-SJct. T.H. 56

Ref. Pt. 182+00.854 - 184+00.328

YEAR BUILT	PROJECT N <sup>o</sup>	DESCRIPTION			CODE N <sup>o</sup>
		TYPE	WIDTH	THICKNESS	
		Gravel	20'	3"	No Record of Constr. Added in 1934.
M	1942 A.F.E. 6	Spot Graveling			205 C.Y./Mi. Maint. Dept.
M	1943 A.F.E. 6	Grav. Resurface (Spots)			359 C.Y./Mi. Maint. Dept.
M	1944 A.F.E. 6	Grav. Resurfacing			89 C.Y./Mi. Maint. Div.
C	1947 2501-02	Grading Stab. Gravel	34' 32'	12"	
C	1948 2501-03	Gravel Base	32'	3"	
C	1948 A.F.E. 30	Bit. Surfacing Bit Surf. Treated (Mixed Prime)	26'	3/4"	503,818.3 Gal.
C	1949 2501-05	Plant Mix Bit.	22'	1 1/2"	
M	1952 A.F.E. 5	Light Bit. Seal	24'		RS-2, 2528 Gal. Agg. 84 C.Y.
M	1959 A.F.E. 605	Light Bit. Seal	25'		RS-2, 2794 Gal. Agg. 105 C.Y.
M	1965 C	Light Bit. Seal	25'		RS-1C, 2452 Gal. Agg. 90 C.Y.
C	2501-07 1975 GRS 4028(4)	PLANT MIX BIT. GRAV. SHOULDERS L+R	24' 8'	9"	
M	1986 SF	Bit. Shouldering	6'	2"	
M	1989 SF	Bit. Sealing			

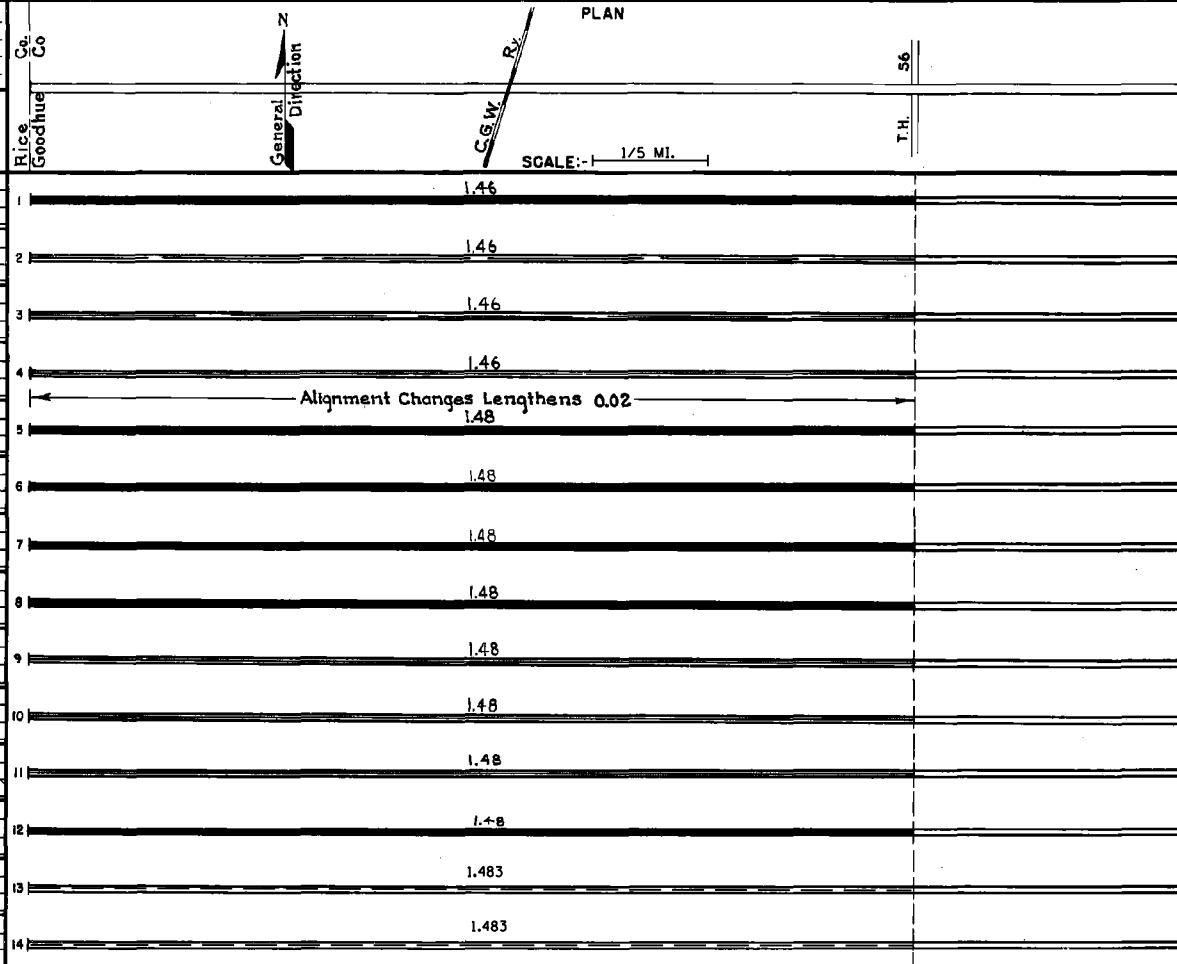

YEARS		TOTAL MILES	UNINCORPORATED		INCORPORATED		RURAL		URBAN	
FROM	TO		RDWY. MI.	BR. MI.	RDWY. MI.	BR. MI.	RDWY. MI.	BR. MI.	RDWY. MI.	BR. MI.
1934	1948	1.48	1.48	0.00	0.00	0.00	1.48	0.00	0.00	0.00
1947		1.48	1.48	0.00	0.00	0.00	1.48	0.00	0.00	0.00

REMARKS: Layout is to scale as of 1934

