

PREPARED BY  
TRAFFIC AND PLANNING DIVISION  
IN COOPERATION WITH  
U.S. DEPARTMENT OF COMMERCE  
BUREAU OF PUBLIC ROADS

STATE OF MINNESOTA  
DEPARTMENT OF HIGHWAYS  
ROAD LIFE STUDIES  
CONSTRUCTION PROJECT LOG RECORD

CONTROL SECTION 2738  
TRUNK HIGHWAY 101  
COUNTY Hennepin  
DISTRICT Metro

LIMITS: Jct. ISTH-94 - Hennepin/Wright Co. Line  
Ref. Pt. 039+00.640 - 041+00.901

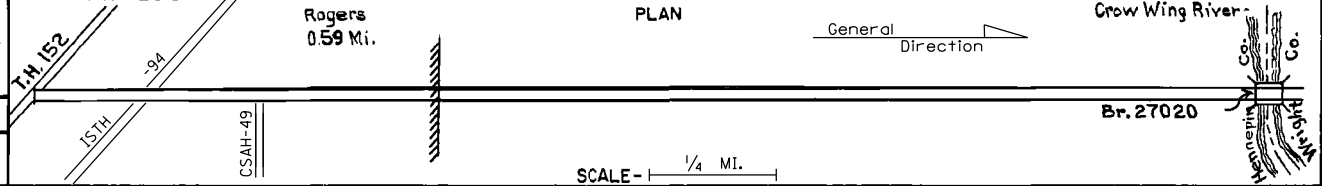

YEAR BUILT	PROJECT NO	DESCRIPTION				REMARKS
		TYPE	WIDTH	THICKNESS		
					0.59 Transferred into T.H. System from C.S.A.H. 150	
1968	2738-05	Br. 27020 Grading, Sub base, Base, Pl. Mix Bit. Surf.	30' 27'	6" 3"	260' B.S.	
1973	2780-05 ITG 094-3 (99) 206	Grading, Base, Pl. Mix Bit. Surf. & P.C. Concrete Surf.	20' 26'	3" 3"	0.44 Mi Grade only SB. 0.33 Mi. 0.05 Mi.	
1981	2738-07	Bit. Resurfacing	24'	1 1/2"	Spec 2361 Spec 2331	
1986	2780-33	Bit. Shouldering	12'	7"	Spec 2331, 2361	
1992	2738-11	Mill & Bit. Overlay	26-24'	3"	Spec 2331, 2341	
1996	2738-10	Bit. Milling & Overlay, Grading, Surfacing, Agg. Base	26' Var.	Var.	Spec. 2361 Class 3, Class 6	
2001	8825-103	Rout & Seal of Bituminous Cracks				
2007	8608-21	Milling, Bit. Overlay	24'	2 1/2"	Spec. 2360	
2010	2780-75	Grading, Bit. Surfacing	var.	var.	Spec. 2360	
2015	2738-28	Grading/Agg. Base, Bit. Surfacing, Conc. Median Barrier	var.	6" 7.5"	Class 6 Spec. 2360 Bit. Shldr. ramps	

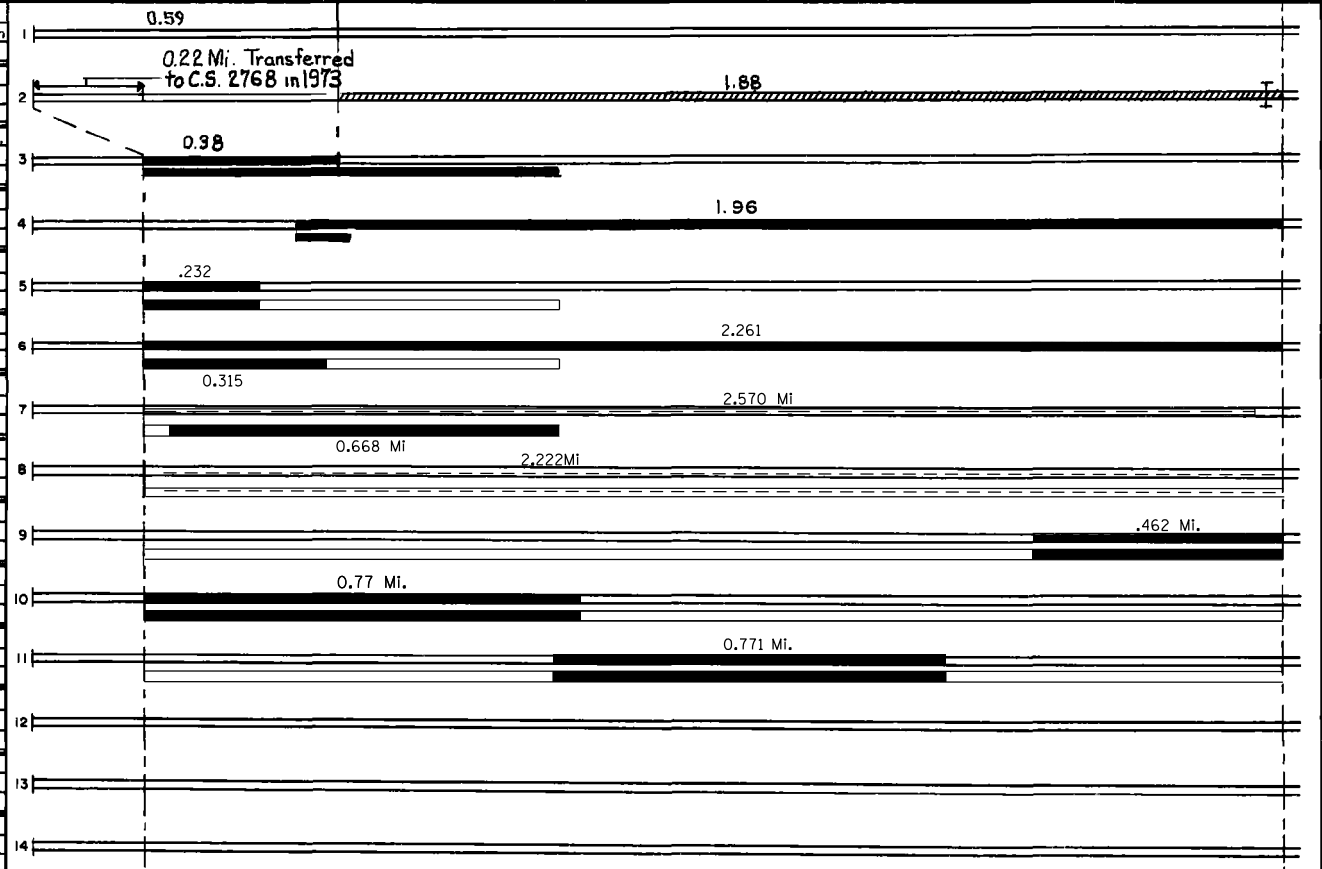

YEARS		TOTAL MILES	UNINCORPORATED		INCORPORATED		RURAL		URBAN		REMARKS
FROM	TO		RDWY. MI.	BR. MI.	RDWY. MI.	BR. MI.	RDWY. MI.	BR. MI.	RDWY. MI.	BR. MI.	
1968	1972	2.47	1.62	0.05	0.80	0.00	2.42	0.05	0.00	0.00	Layout is to scale as of 1968.
1973		2.26	1.62	0.05	0.55	0.00	2.21	0.05	0.00	0.00	