

PREPARED BY
TRAFFIC AND PLANNING DIVISION
IN COOPERATION WITH
U.S. DEPARTMENT OF COMMERCE
BUREAU OF PUBLIC ROADS

STATE OF MINNESOTA
DEPARTMENT OF HIGHWAYS
ROAD LIFE STUDIES
CONSTRUCTION PROJECT LOG RECORD

CONTROL SECTION **3515**
TRUNK HIGHWAY **175**
COUNTY **Kittson**
DISTRICT **252**

LIMITS: E. End of Bridge over Red River of the North
(W. State Line) - Jct. T.H. 75 in Hallock

Ref. Pt. 000+00.124 - 010+00.012

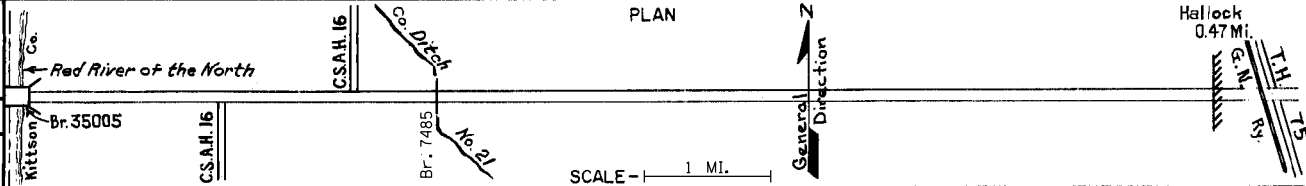

DIST No.	YEAR BUILT	PROJECT NO.	DESCRIPTION			REMARKS
			TYPE	WIDTH	THICKNESS	
			Gravel (0.81 mi.) Mixed Bit. (0.21 mi.)	20' 24'		No Record of Const. Added to system in 1961
1559	1960		Grading Gravel Multi-Plate Arch Culv.	34' 28'		Built as S.P. 35-603-01 Added to system in 1961
	M 1962		Gravel Resurfacing			Gravel, 3584 Tons
666	C 1969	3515-05	Grade & Gravel	46'		
1768	C 1971	3515-06	Grading P.C. Conc. Gravel Shoulders	42' 24' 8'	7"	Rt. & Lt.
1968	C 1968	3515-06	RR KING SIGNALS			
3078	M 1978	SF	BIT SURFACING IN SPOTS	24		Too Yds.
3079	M 1979	SF	GRAVEL SHOULDER REPAIR	4'-7'		10,000 Yds.
	M 1984	M4041	Pavement Joints Joint Seal Crack Repair			29,724 Lbs. - Sealer 63,810 Lin. Ft. 10,500 Lin. Ft.
	M 1997	M97293	Bit. Shoulder	6 1/2'	2"	Spec. 2331
	C 2001	3516-14	Aggregate Base Grading Bit. Overlay	48' 52' 48'	9' Var.	Agg. Class 5 & 6 Spec. 2360
	C 2001	3515-11	Aggregate Base Grading Bit. Overlay	8' 8' 24'	var	Spec 2350
	M 2016	8822-184	Agg. Surfacing on shoulders	7'-8'		class 1
	C 2017	3515-16	Grading Bit. Mill & Overlay ML, TL, shldrs, approaches	var. 2"-4"		Spec. 2360 8" agg. base

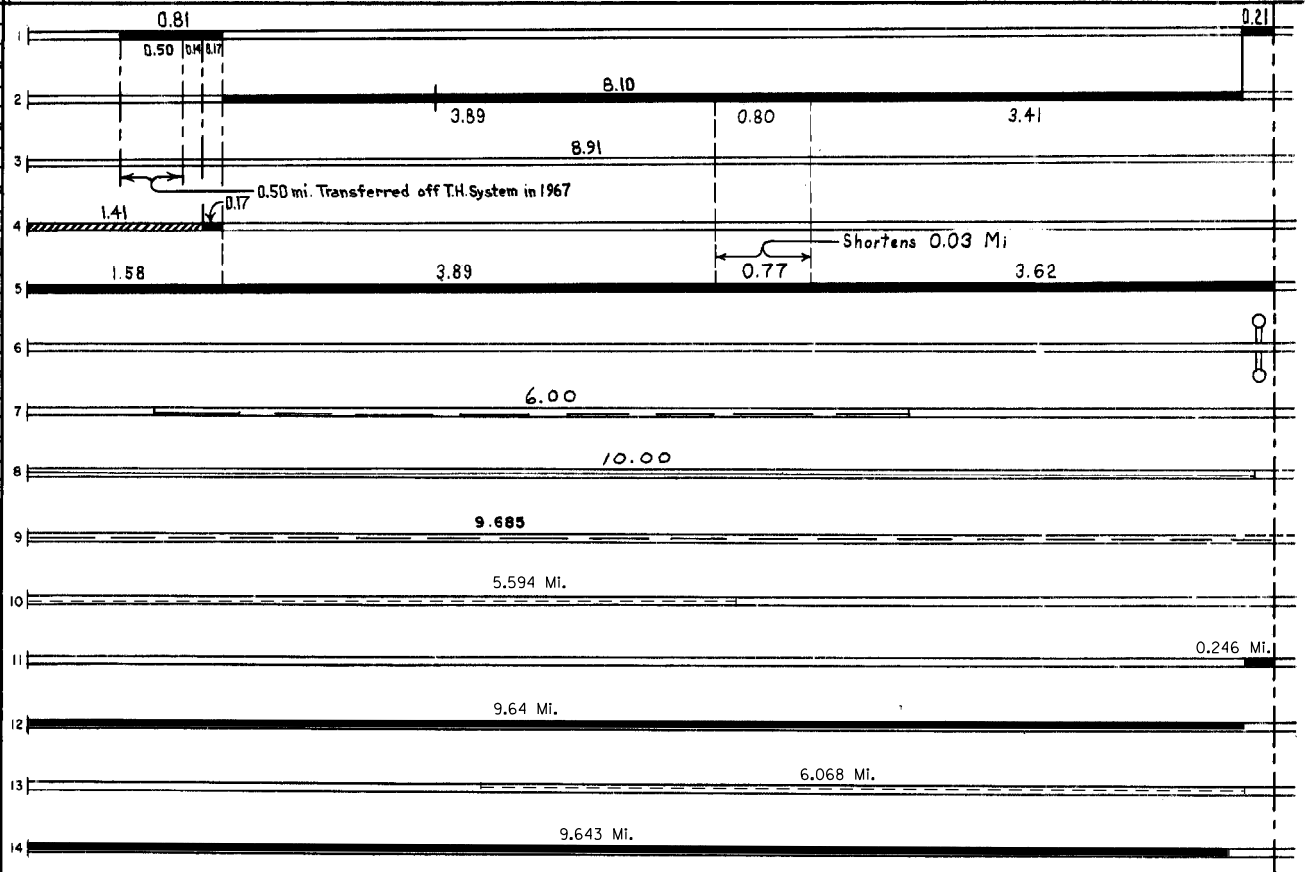

YEARS		TOTAL MILES	UNINCORPORATED		INCORPORATED		RURAL		URBAN	
FROM	TO		RDWY. MI.	BR. MI.	RDWY. MI.	BR. MI.	RDWY. MI.	BR. MI.	RDWY. MI.	BR. MI.
1961	1966	9.12	8.64	0.01	0.47	0.00	8.64	0.01	0.47	0.00
1967	1968	8.62	8.14	0.01	0.47	0.00	8.14	0.01	0.47	0.00
1969	1970	9.89	9.41	0.01	0.47	0.00	9.41	0.01	0.47	0.00
1971		8.86	8.38	0.01	0.47	0.00	8.38	0.01	0.47	0.00

REMARKS: Layout is to scale as of 1969
FOR OTHER PROJECTS SEE DIST. NO. 762, 1969, 281