

PREPARED BY  
HIGHWAY PLANNING SURVEY  
IN COOPERATION WITH  
U.S. PUBLIC ROADS ADMINISTRATION

STATE OF MINNESOTA  
DEPARTMENT OF HIGHWAYS  
ROAD LIFE STUDIES  
CONSTRUCTION PROJECT LOG RECORD

CONTROL SECTION 5006  
TRUNK HIGHWAY 63  
COUNTY Mower  
DISTRICT 6A

LIMITS: Jct. T. H. 16 - No. Co. Line

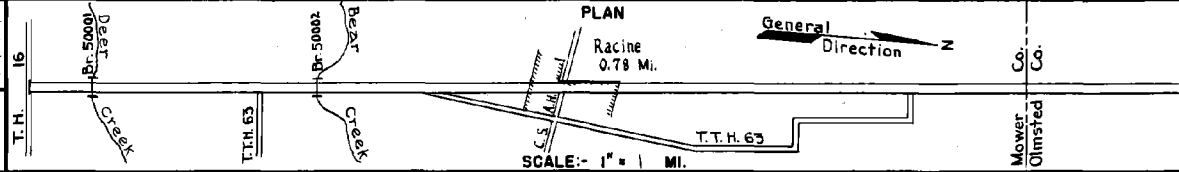

YEAR BUILT	PROJECT N <sup>o</sup>	DESCRIPTION			CODE N <sup>o</sup>
		TYPE	WIDTH	THICKNESS	
1921		Gravel Br. 2521	22' 18'	2"	No Record of Const. 70' L.T.
1931	63-59-26A	Grading Br. 5134 & 5135	40' 27'		2-75' L.T.
1932	63-59-26A	Gravel	24'	2"	900 C.Y./Mile.
1932	63-59-26A	Gravel	24'	2 1/2"	200 C.Y./Mile.
1932	63-59-26A	Oil Tr. Gravel	24'	1"	14055 Gal./Mile. Maint. Dept.
1934	63-59-26A	Waterbound Mac.	22'	7"	4000 Tons/Mile.
1935	63-59-26A	Bit Conc. Plant Mix.	20'	2 3/4"	1200 Tons/Mile.
M	1941 A.F.E. 44	Frost Boil Corr. & Backfill (Spots)			Maint. Dept.
M	1943 A.F.E. 4	Spot Treat Bit. Surf. Repair	24'		RT-5&6, 397 G./Mi.
C	1945 A.F.E. 26	Bit. Resurfacing Bit. Plant Mix	20'	7/8"	1831T- Level Course 4741T- Wear Course Maint. Div.
M	1947 A.F.E. 5	Bit. Seal Coat	20'		AE-1, 23461 Gal. Agg. 753 C.Y.
M	1949 A.F.E. 4	Spot Treat Bit. Surf. Repair	24'		MC-3, 3303 Gal. Agg. 144 C.Y.
M	1953 A.F.E. 604 A.F.E. 605	Spot Treat Bit. Surf. Repair Light Bit Seal (866 M)	20'		MC-3 & RCS-2, 16995 Gal. Agg. 661 C.Y.
M	1955 A.F.E. 605	Light Bit. Seal	20'		RCS-1, 19059 Gal. Agg. 578 Tons

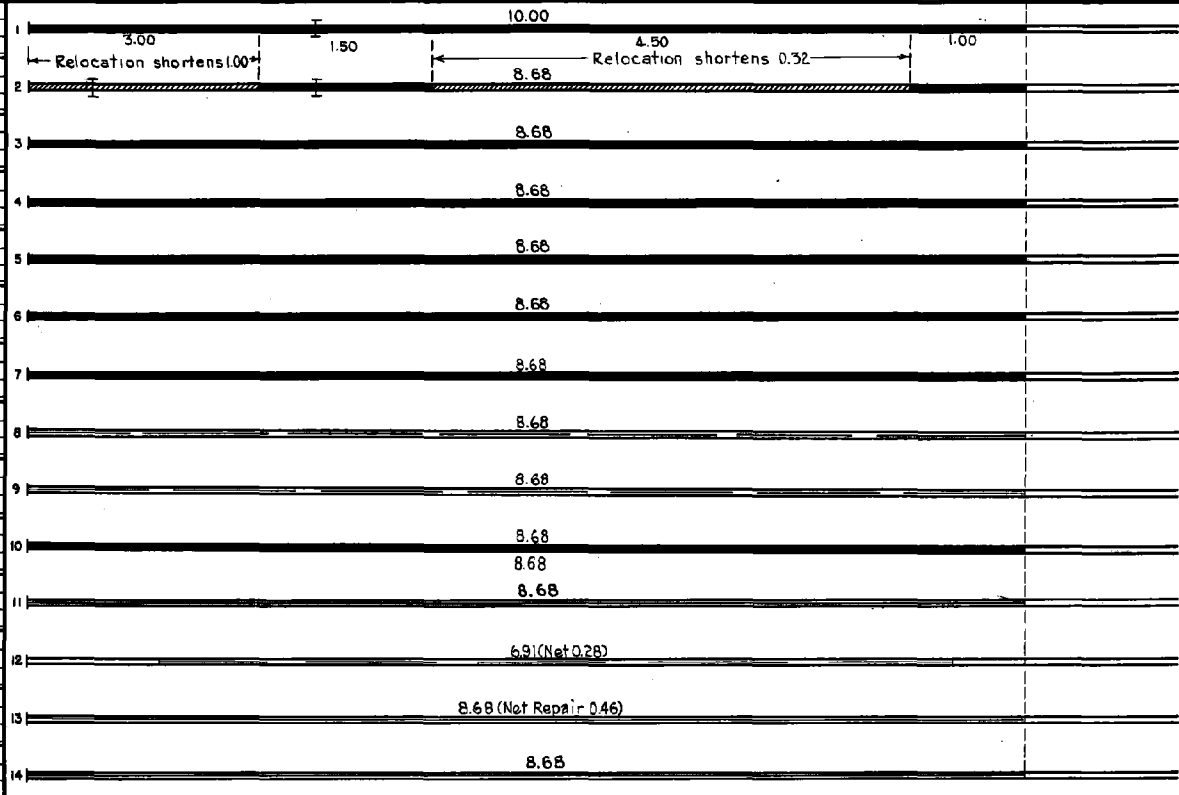

YEARS		TOTAL MILES	UNINCORPORATED		INCORPORATED		RURAL		URBAN	
FROM	TO		RDWY. MI.	BR. MI.	RDWY. MI.	BR. MI.	RDWY. MI.	BR. MI.	RDWY. MI.	BR. MI.
1921	1930	10.00	9.99	0.01	0.00	0.00	9.99	0.01	0.00	0.00
1931	1938	8.68	8.65	0.03	0.00	0.00	8.65	0.03	0.00	0.00
1939	1969	8.68	7.87	0.03	0.78	0.00	8.65	0.03	0.00	0.00
1970		8.68	7.79	0.05	0.78	0.00	8.63	0.05	0.00	0.00

REMARKS: Layout is to scale as of 1931

(1) Accumulated thickness. (2) This work not done under this project number but lies within the limits of this project.

PREPARED BY  
HIGHWAY PLANNING SURVEY  
IN COOPERATION WITH  
U. S. PUBLIC ROADS ADMINISTRATION

STATE OF MINNESOTA  
DEPARTMENT OF HIGHWAYS  
ROAD LIFE STUDIES  
CONSTRUCTION PROJECT LOG RECORD

CONTROL SECTION 5006  
TRUNK HIGHWAY 63  
COUNTY Mower  
DISTRICT 6A

LIMITS: Jct. T.H. 16 - N. Co. Line

Ref. Pt. 018+00.601 - 027+00.234

YEAR BUILT	PROJECT N <sup>o</sup>	DESCRIPTION			CODE N <sup>o</sup>
		TYPE	WIDTH	THICKNESS	
M		Spot Treat.			
1957	A.F.E. 604	Bit. Surf. Repair	24'		Bit. Mix 504 Tons
M		Repair Base			36 Tons Base
1958	A.F.E. 604	Restore Bit. Surf.	24'		Bit. Mix. 24 Tons
M		Spot Treat			MC-2, 4035 Gal.
1959	A.F.E. 604	Bit. Surf. Repair	24'	3/4"	Agg. 280 Tons
	A.F.E. 605	Light Bit. Seal	21'		RS-1, 18948 Gal.
M		Spot Treat			MC-2, 10225 Gal. &
1961		Bit. Surf. Repair	24'		1223 tons Bit. Mix
M					Rd. Mix 4124 Tons
1962		Bit. Surf. Repair	20'		
M					RS-2K, 11926 Gal.
1964	C	Light Bit. Seal	21'		Agg. 454 C.Y.
C		Grade Base			Remove Br. 5134 &
1970	5006-08	Pl. Mix. Bit. Surf.	24'	3"6"	Br. 5135
		Pl. Mix. Bit. Shoulder			8' Right & Left
C		Br. No. 50001			137' P.P.G
1970	5006-08	Br. No. 50002			142.6 P.P.G
C					
1982	5006-14	Bit. Surfacing	24'	2 1/4"	3/4" Spec. 2361
	FO56-1(53)	Bit. Shoulders	8'	2 1/4"	
C		Bit. Overlay	24'	3 1/2"	Spec. 2331
1994	5006-16	Edge Drain			
		Gravel Surfacing	2'	3 1/2"	Class 2
M					
1997	5006-17	Major Crack Repair			
M					
2019	8826-193	Bituminous Chip Seal	====		

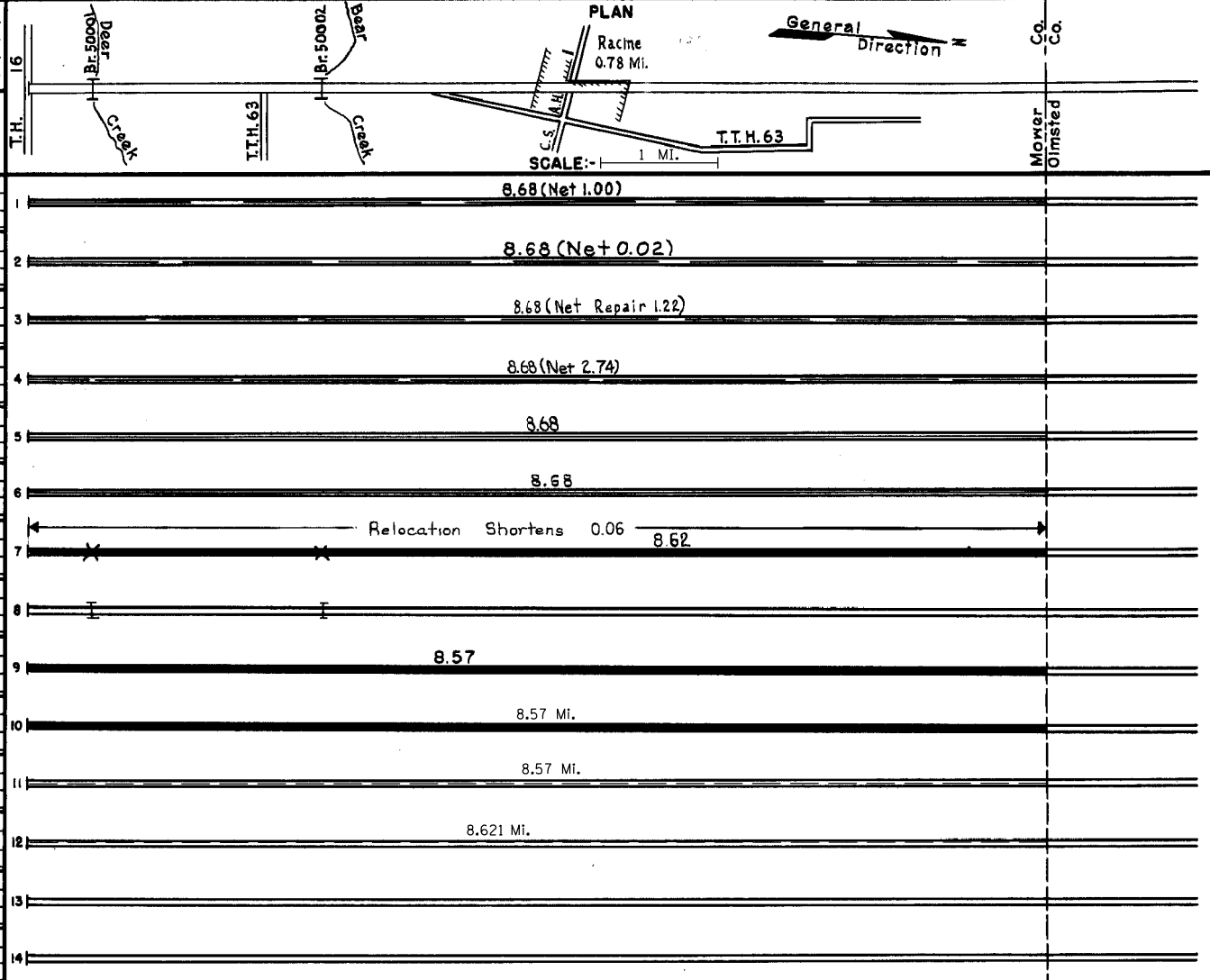

YEARS		TOTAL MILES	UNINCORPORATED		INCORPORATED		RURAL		URBAN	
FROM	TO		RDWY. MI.	BR. MI.	RDWY. MI.	BR. MI.	RDWY. MI.	BR. MI.	RDWY. MI.	BR. MI.

REMARKS: See Sheet No. 1