

PREPARED BY  
HIGHWAY PLANNING SURVEY  
IN COOPERATION WITH  
U. S. PUBLIC ROADS ADMINISTRATION

STATE OF MINNESOTA  
DEPARTMENT OF HIGHWAYS  
ROAD LIFE STUDIES  
CONSTRUCTION PROJECT LOG RECORD

CONTROL SECTION 5621  
TRUNK HIGHWAY 78  
COUNTY Otter Tail  
DISTRICT 4A

LIMITS: S. Jct. T.H. 108 in Ottertail - Jct. T.H. 10

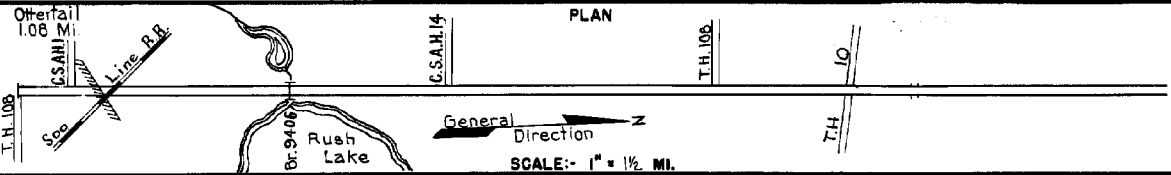

YEAR BUILT	PROJECT N <sup>o</sup>	DESCRIPTION			CODE N <sup>o</sup>
		TYPE	WIDTH	THICKNESS	
		Earth	24'		No Record of Const.
		Grading	24'		Added in 1934.
1921		Gravel Br. 3300	24'	3 3/4"	Co 2002. Added in 1934. 1200 C.Y./Mi. 60 L.T.
		Tar Tr. Gravel	24'	1"	No Record of Const. Added in 1934.
1934	78-180-21-1	Grading	30'		
1935		Oil Tr. Gravel	20'	1"	Maint. Dept.
1936	78-181-22-1	Grading	30'		
1936	(1) 78-180-21-1	Gravel	28'	1 3/4"	854 C.Y./Mile Maint. Dept.
1936	(1) 78-181-22-1	Gravel	28'	1 3/4"	854 C.Y./Mile Maint. Dept.
1937	A.F.E. 14.	Mixed Bituminous	24'	1 1/2"	
	A.F.E. 15				Maint. Dept.
M					Bit. 3082 Gal./Mi. Sand 85 C.Y./Mi.
1940	A.F.E. 9	Bit. Seal Coat			Maint. Dept.
M					RG3, 3517 Gal./Mi. Agg. 119 C.Y./Mi.
1941	A.F.E. 22	Bit. Seal Coat			Maint. Dept.
C	A.F.E. 13	Spot Grav. Lifts. Bit.			SC-3b, 68145 Gal.
1946	A.F.E. 21	Resurf. & Fog Seal Mixed Bit.	21-28'	1"	Agg. 4200 C.Y.
C		Sand Lift	18"		MC3, 4639 Gal.
1947	A.F.E. 24	Bit. Surfacing Bit. Surf. Treat.	26'		Agg. 200 C.Y. (Mixed Prime)
M		Spot Treat.			MC3, 7119 Gal.
1949	A.F.E. 4	Bit. Surf. Repair	24'		Agg. 589 Tons

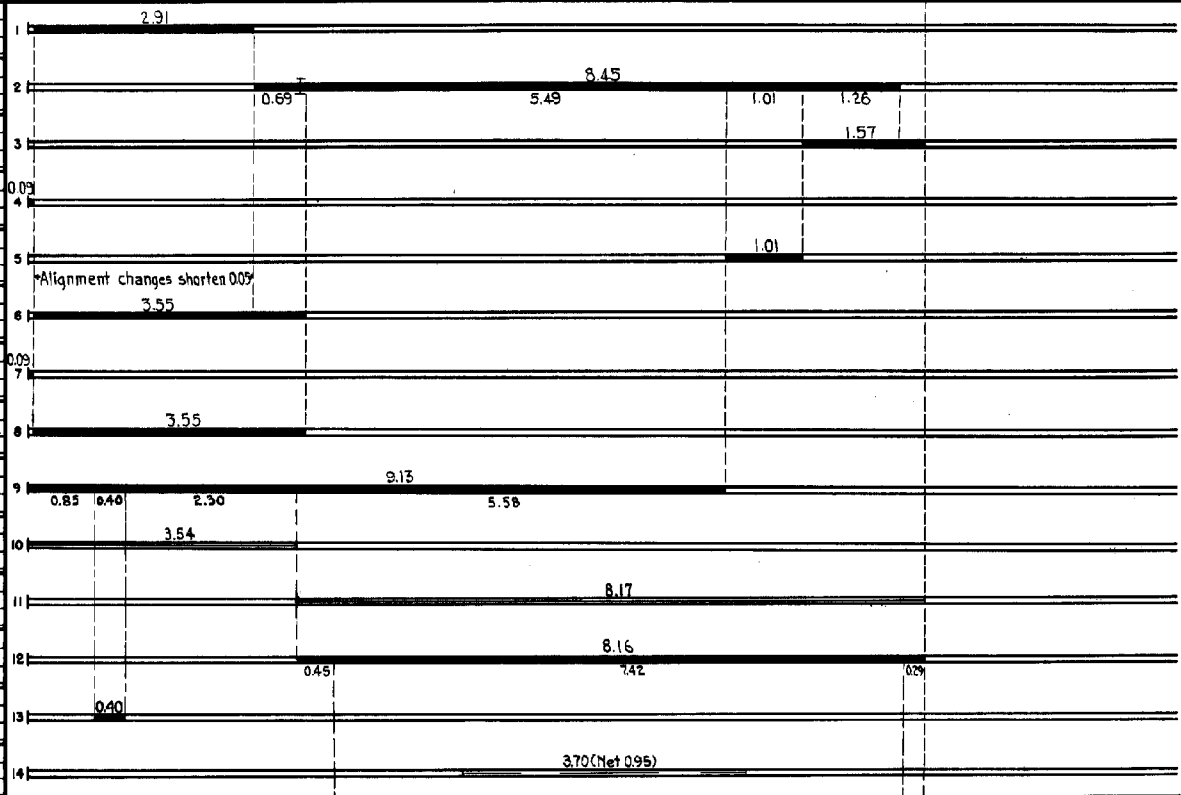

YEARS FROM	TO	TOTAL MILES	UNINCORPORATED		INCORPORATED		RURAL		URBAN	
			RDWY. MI.	BR. MI.	RDWY. MI.	BR. MI.	RDWY. MI.	BR. MI.	RDWY. MI.	BR. MI.
1934	1935	11.76	0.07	0.0	6.5	0.00	11.18	0.01	0.57	0.00
1936	1938	11.71	0.05	0.0	6.5	0.00	11.13	0.01	0.57	0.00
1939	1942	11.71	0.02	0.03	6.6	0.00	11.10	0.03	0.58	0.00
1943		11.70	0.02	0.03	6.5	0.00	11.10	0.03	0.57	0.00

REMARKS: Layout is to scale as of 1936.

(1) This work not done under these project numbers but lies within the limits of these projects.

4-75

PREPARED BY  
HIGHWAY PLANNING SURVEY  
IN COOPERATION WITH  
U.S. PUBLIC ROADS ADMINISTRATION

STATE OF MINNESOTA  
DEPARTMENT OF HIGHWAYS  
ROAD LIFE STUDIES  
CONSTRUCTION PROJECT LOG RECORD

CONTROL SECTION 5621  
TRUNK HIGHWAY 78  
COUNTY Otter Tail  
DISTRICT 4A

LIMITS: S.Jct.T.H.108 in Ottertail - Jct.T.H.10

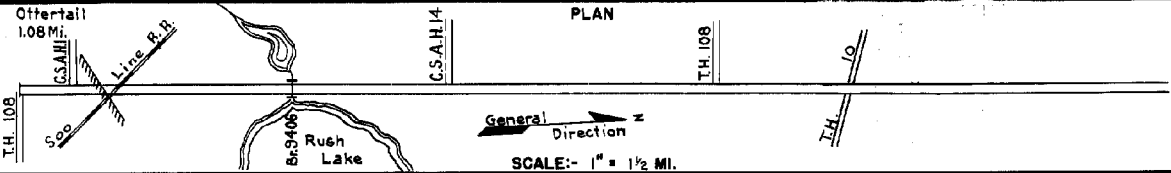

YEAR BUILT	PROJECT N <sup>o</sup>	DESCRIPTION			CODE N <sup>o</sup>
		TYPE	WIDTH	THICKNESS	
C 1949	A.F.E. 17	Bit. Resurfacing Mixed Bit.	24'	1" added	
C 1949	5621-04	Grading Plant Mix Bit.	50'	2"	
M 1951	A.F.E. 4	Light Bit. Seal	24'		
M 1952	A.F.E. 5	Light Bit. Seal	48'		
M 1958	A.F.E. 605	Light Bit. Seal	25'		
C 1959	5621-06	Br. 9406	30'		
C 1959	5621-05	Gravel Base Road Mix Bit.	36' 2.6'	4"-8" 1 1/2"	
M 1962		Light Bit. Seal	25'		
C 1963	5621-10	Plant Mix Bit.	24'	2"	
M 1970	SF	Seal Coat	24'- 48'		
C 1970	5621-13	Plant Mix Bit. Agg Shoulders	22'	2"-19"	
M 1974	-15	Seal Coat	24' 50'		
M 1983	SF	Bit. Shoulders Bit. Overlay	6' 24'	4 1/2" 1 1/2"	
M 1983	SF	Bit. Overlay Bit. Rt. Turn Ln.	24' 24' 12'	1" 1" 2"	
M 1984	SF	Seal Coat	24'		

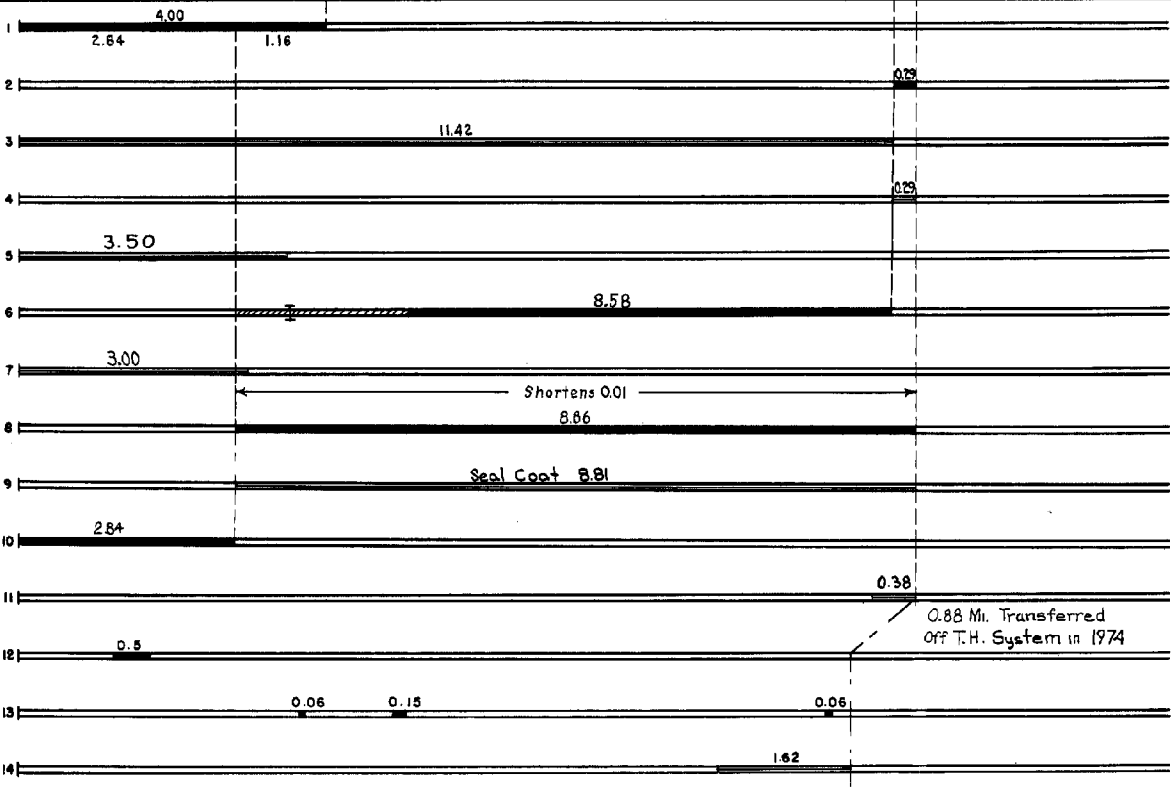

YEARS FROM	TOTAL MILES TO	UNINCORPORATED		INCORPORATED		RURAL		URBAN	
		RDWY. MI.	BR. MI.	RDWY. MI.	BR. MI.	RDWY. MI.	BR. MI.	RDWY. MI.	BR. MI.

REMARKS: See Sheet No. 1

