

PREPARED BY
HIGHWAY PLANNING SURVEY
IN COOPERATION WITH
U.S. PUBLIC ROADS ADMINISTRATION

STATE OF MINNESOTA
DEPARTMENT OF HIGHWAYS
ROAD LIFE STUDIES
CONSTRUCTION PROJECT LOG RECORD

CONTROL SECTION 7804
TRUNK HIGHWAY 28
COUNTY Traverse
DISTRICT 4B

LIMITS: W. State Line - S. Co. Line.

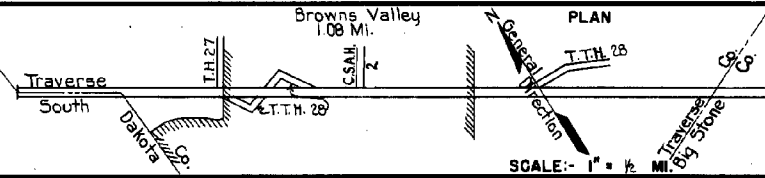

YEAR BUILT	PROJECT N ^o	DESCRIPTION			CODE N ^o
		TYPE	WIDTH	THICKNESS	
		Gravel	27'4"	2"	No Record of Constr.
1928	28-28-31A	Grading Gravel	28'4"	2 1/2"	1200 C.Y./Mile.
1934	(1) 28-28-31A	Oil Tr. Gravel	23'	1"	Oil # 2-70 16000 Gal./Mile. Maint. Dept.
1935	(1) 28-28-31A	Gravel	26'	2 1/2"	1200 C.Y./Mile.
1935	(1) 28-28-31A	Oil Tr. Gravel	23'	1"	10000 Gal./Mile. Maint. Dept.
1938	7804-02	Grading	34'		
	7804-03	Stab. Gravel (2)	32'	1/2"	
1939	7804-04	Bit. Surf. Tr.	32'	3/4"	
M	1941 A.F.E. 25	Bit. Seal Coat	26'		RC3 2604 Gal./Mi. Grav. 78 C.Y./Mi. Maint. Dept.
M	1943 A.F.E. 4	Bit. Surf. Repair			MC3 10079 Gal./Mi. Grav. 379 C.Y./Mi. Maint. Dept.
M	1944 A.F.E. 4	Spot Treat. Bit. Surf. Repair	24'		RF4 4449 Gal./Mi. Grav. 160 C.Y./Mi. Maint. Div.
M	1945 A.F.E. 4 A.F.E. 23(?)	Bit. Surf. Repair	24'		MG2&RT6 72546/M. Grav. 300 C.Y./Mi. Maint. Div.
M	1945 A.F.E. 5	Bit. Seal Coat	26'		Bit. 3841 Gal./Mi. Grav. 114 C.Y./Mi. Maint. Div.
C	1946 7804-07	Grading Gravel Base Plant Mix Bit.	32'4" 32'4"	5" 3 1/2"	
M	1947 A.F.E. 4	Spot Treat. Bit. Surf. Repair	24'		MC-3 1325 Gal. Aqg. 105 tons

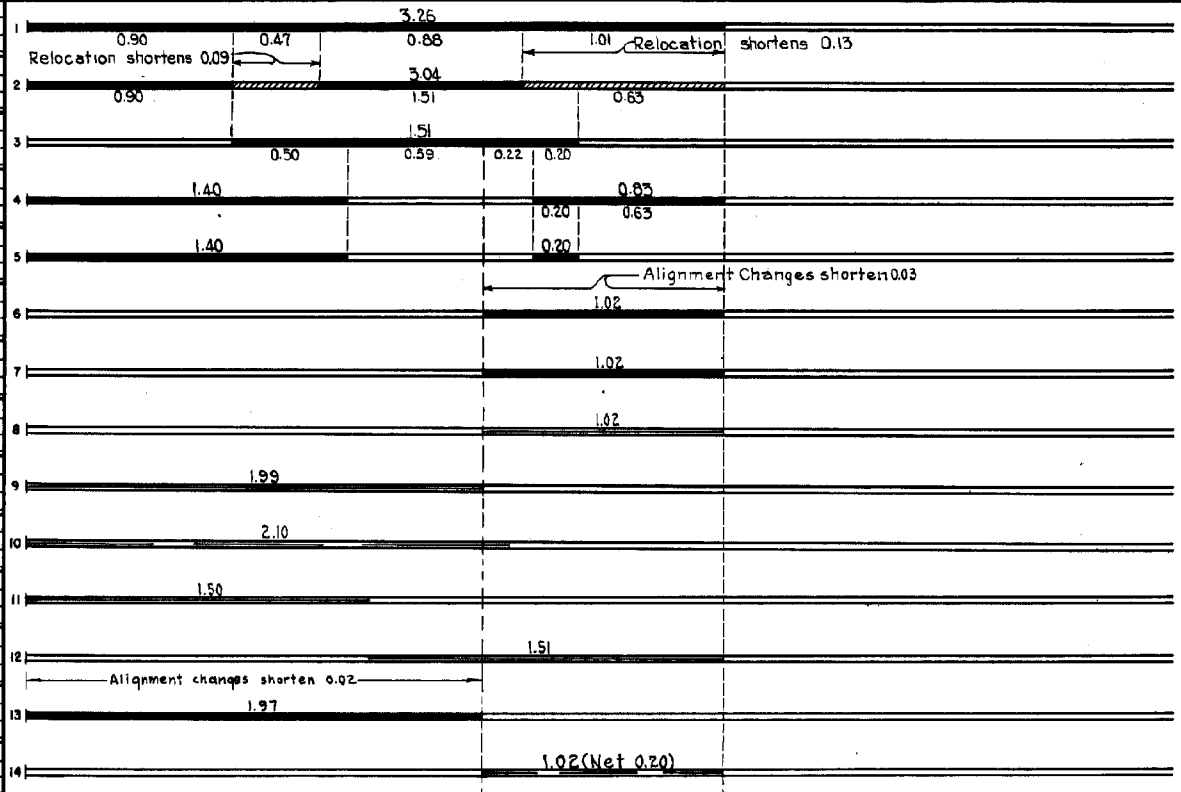

YEARS FROM	TO	TOTAL MILES	UNINCORPORATED		INCORPORATED		RURAL		URBAN	
			RDWY. MI.	BR. MI.	RDWY. MI.	BR. MI.	RDWY. MI.	BR. MI.	RDWY. MI.	BR. MI.
1921	1927	3.26	2.08	0.00	1.18	0.00	2.08	0.00	1.18	0.00
1928	1937	3.04	1.95	0.00	1.09	0.00	1.95	0.00	1.09	0.00
1938	1945	3.01	1.92	0.00	1.09	0.00	1.92	0.00	1.09	0.00
1946		2.99	1.91	0.00	1.08	0.00	1.91	0.00	1.08	0.00

REMARKS: Layout is to scale as of 1928.
(1) This work not done under this project number but lies within the limits of this project. (2) 3" Upper layer is 32' wide - Balance 26' wide.

PREPARED BY
HIGHWAY PLANNING SURVEY
IN COOPERATION WITH
U.S. PUBLIC ROADS ADMINISTRATION

STATE OF MINNESOTA
DEPARTMENT OF HIGHWAYS
ROAD LIFE STUDIES
CONSTRUCTION PROJECT LOG RECORD

CONTROL SECTION 1804
TRUNK HIGHWAY 28
COUNTY Traverse
DISTRICT 4B

LIMITS: West State Line to South County Line

Ref. Pt. 000+00.000 - 002+00.990

YEAR BUILT	PROJECT N ^o	DESCRIPTION				CODE N ^o
		TYPE	WIDTH	THICKNESS	REMARKS	
M	1950	A.F.E. 4	Spot Treat			RC-1, 503, 727 Gal. Agg. 64 C.Y. & 8250
			Bit. Surface Repair	24'		Tons
			Bit. Fog Seal	24'		
C	1951	7804-09	Grav. Base (Widening)	30'	10"	15 Rt. & Lt.
			Plant Mix Bit. (Widening)	30'	2"	Spot Base Repair
			Plant Mix Bit.	24'	1 1/2"	
M	1954	A.F.E. 605	Light Bit. Seal	24'		RC-1, 5500 Gal. Agg. 190 C.Y.
M	1958	A.F.E. 605	Light Bit. Seal	25'		RC-2, 7792 Gal. Agg. 262 Tons
C	1963	7804-12	Grading			Rt. & Lt. of Rdwy. Inplace
			Plant Mix Bit. (Base)	0'-2"		Over Surf. Inplace
			Plant Mix Bit.	24'	1 1/2"	
M	1964	c	Light Bit. Seal	VW		RC-3, 4198 Gal. Agg. 120 C.Y.
M	1965	c	Light Bit. Seal	25'		RS-1C, 6241 Gal. Sand, 176 C.Y.
M	1974	-13	Light Bit. Seal			
C	1982	7804-14	Bituminous Surfacing	24'	3"	
			Aggregate Shoulders			
C	1985	7804	Bit. Seal Coat	24'		Sp. 2356 - FA-2 10,291 Gal. - 397 Cu. Yd.
M	1997	7804-17	Bit. Overlay	Var.	1 1/2"	Spec. 2331
M	2002	8824-33	Aqq. Seal			
S	2011	7804-17	Milling	24'	2"	
			Bit. Overlay	24'	2"	Spec. 2360
			Comb. Shldr.-Bit.	2'	2"	Agg.-Cl. 1

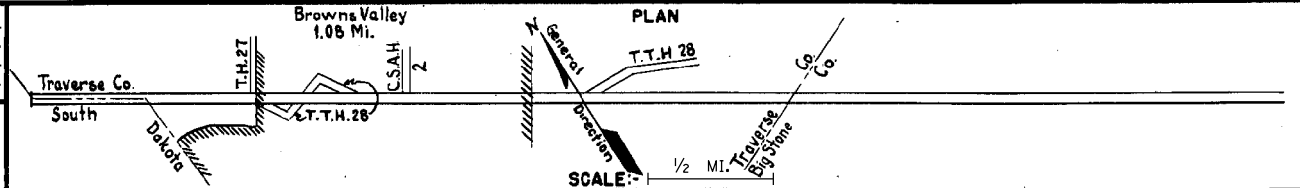

1	Fog Seal 1.97	Repair 1.02 (Net 0.17)
2		1.02
3	1.97	
4	2.99	
5	2.99	
6	1.18	
7	2.99	
8	2.99	
9	2.99	
10	2.99	
11	2.99 MI.	
12	2.99 MI.	
13	2.987 MI.	
14		

YEARS FROM	TOTAL MILES TO	UNINCORPORATED		INCORPORATED		RURAL		URBAN	
		RDWY. MI.	BR. MI.	RDWY. MI.	BR. MI.	RDWY. MI.	BR. MI.	RDWY. MI.	BR. MI.

REMARKS: See Sheet N^o 1
(3) Contract not final but work substantially complete.