

PREPARED BY  
HIGHWAY PLANNING SURVEY  
IN COOPERATION WITH  
U.S. PUBLIC ROADS ADMINISTRATION

STATE OF MINNESOTA  
DEPARTMENT OF HIGHWAYS  
ROAD LIFE STUDIES  
CONSTRUCTION PROJECT LOG RECORD

CONTROL SECTION 8213  
TRUNK HIGHWAY B  
COUNTY Washington  
DISTRICT 9A

LIMITS: Jct. T.H. 61 in Forest Lake - N. Co. Line.

Forest Lake  
0.28 Mi. PLAN

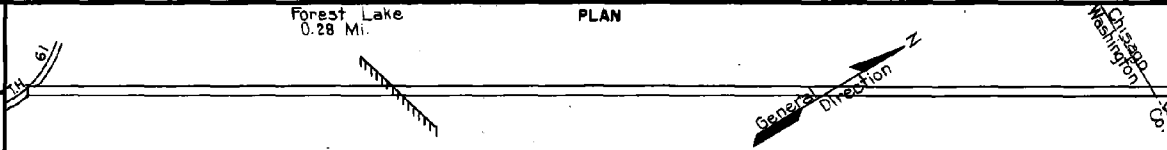

YEAR BUILT	PROJECT N <sup>o</sup>	DESCRIPTION			CODE N <sup>o</sup>
		TYPE	WIDTH	THICKNESS	
		Asphalt	18'	2"	No Record of Constr.
M	A.F.E. 27	Bit Retreat	20'		Added in 1934.
M	A.F.E. 4	Spot Treat Blt. Surf. Repair	20'		RT-6, 2065 Gal./Mi. Agg. 122 C.Y./Mi. Maint. Dept.
C	A.F.E. 4	Bit Resurfacing Mixed Bit.	24'	1 1/2" added	RT-6, 11290 Gal./Mi. Grav. 560 C.Y./Mi. Maint. Div.
M	A.F.E. 4	Light Bit. Seal	20'		RT-8, 2049 Gal. Agg. 62 C.Y.
C	8213-02	Grading Gravel Const. C55 Culv.	36' / 24'	2 1/2"	0.35 Mi. Divided Highway 1200 C.Y./Mi.
C	8213-03	Concrete	22' / 19'	9" / 8"	

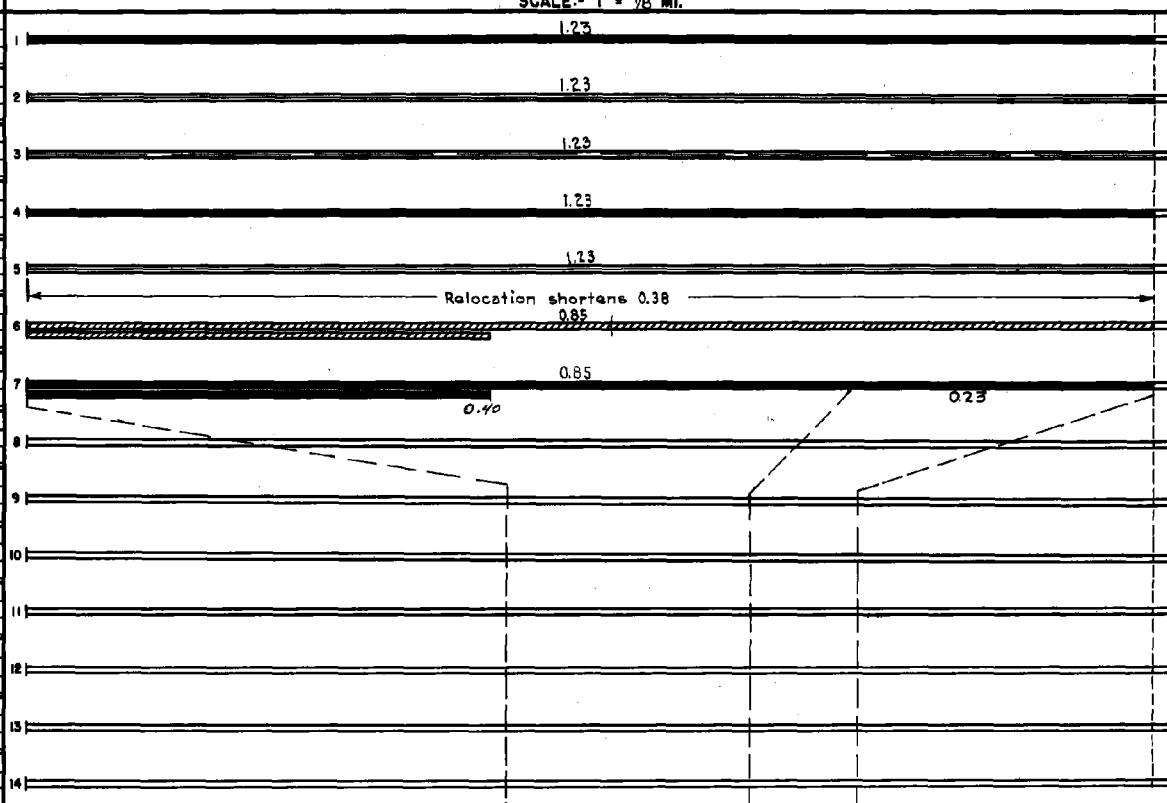

YEARS		TOTAL MILES	UNINCORPORATED		INCORPORATED		RURAL		URBAN	
FROM	TO		RDWY. MI.	BR. MI.	RDWY. MI.	BR. MI.	RDWY. MI.	BR. MI.	RDWY. MI.	BR. MI.
1934	1950	1.25	0.57	0.00	0.66	0.00	0.57	0.00	0.66	0.00
1951		0.85	0.57	0.00	0.28	0.00	0.57	0.00	0.28	0.00

REMARKS: Layout is to scale as of 1934.

PREPARED BY  
TRAFFIC AND PLANNING DIVISION  
IN COOPERATION WITH  
U.S. DEPARTMENT OF COMMERCE  
BUREAU OF PUBLIC ROADS

STATE OF MINNESOTA  
DEPARTMENT OF HIGHWAYS  
ROAD LIFE STUDIES  
CONSTRUCTION PROJECT LOG RECORD

CONTROL SECTION 8213  
TRUNK HIGHWAY 9  
COUNTY Washington  
DISTRICT Metro

LIMITS: Jct. T.H. 35 to N. Co. Line  
Ref. Pt. 000+00.000 - 001+00.835

YEAR BUILT	PROJECT NO	DESCRIPTION			
		TYPE	WIDTH	THICKNESS	REMARKS
1969	8280-06	Grading			Divided Highway
	8280-08	Base, P.C. Concrete	20'26"	8"	
		Pl. Mix. Bit. Shldrs.			10' out. 3' in.
1969	8213-05	Grade, Base, P.C. Conc.	20'28"	8"	Divided Highway
		Bc 82001			240.8' B.S.
		Bc 82002			291.5' P.P.G.
1970	8213-06	Pl. Mix. Bit. Shldrs.			
1971	8213-08	Fencing			12,959 ft. 60" Chain Link
1978	8213-16	Pl. Mix. Bit. Resurf.	20'28"	1"	
1981	8213-82001	Repair Br. 82001 & Br. 82002	2-36'	2-36'	2" Min Low Slump Conc. Wearing Course
1984	8213	Conc. Joint Repair			Cont. No. 19112
1988	8213-19	Bit. Overlay			
		By-pass Lanes			
1992	M4532	Conc. Pavement			
		Repair			
2000	8213-20	Bit. Overlay	24'	var.	Spec 2350 & 2360
2005	8825-155	Bit. Crack Repair			Spec. 2331
2011	8213-23	Milling	var.	2"	Spec. 2360
	1308-21	Bit. Overlay	var.	2"	

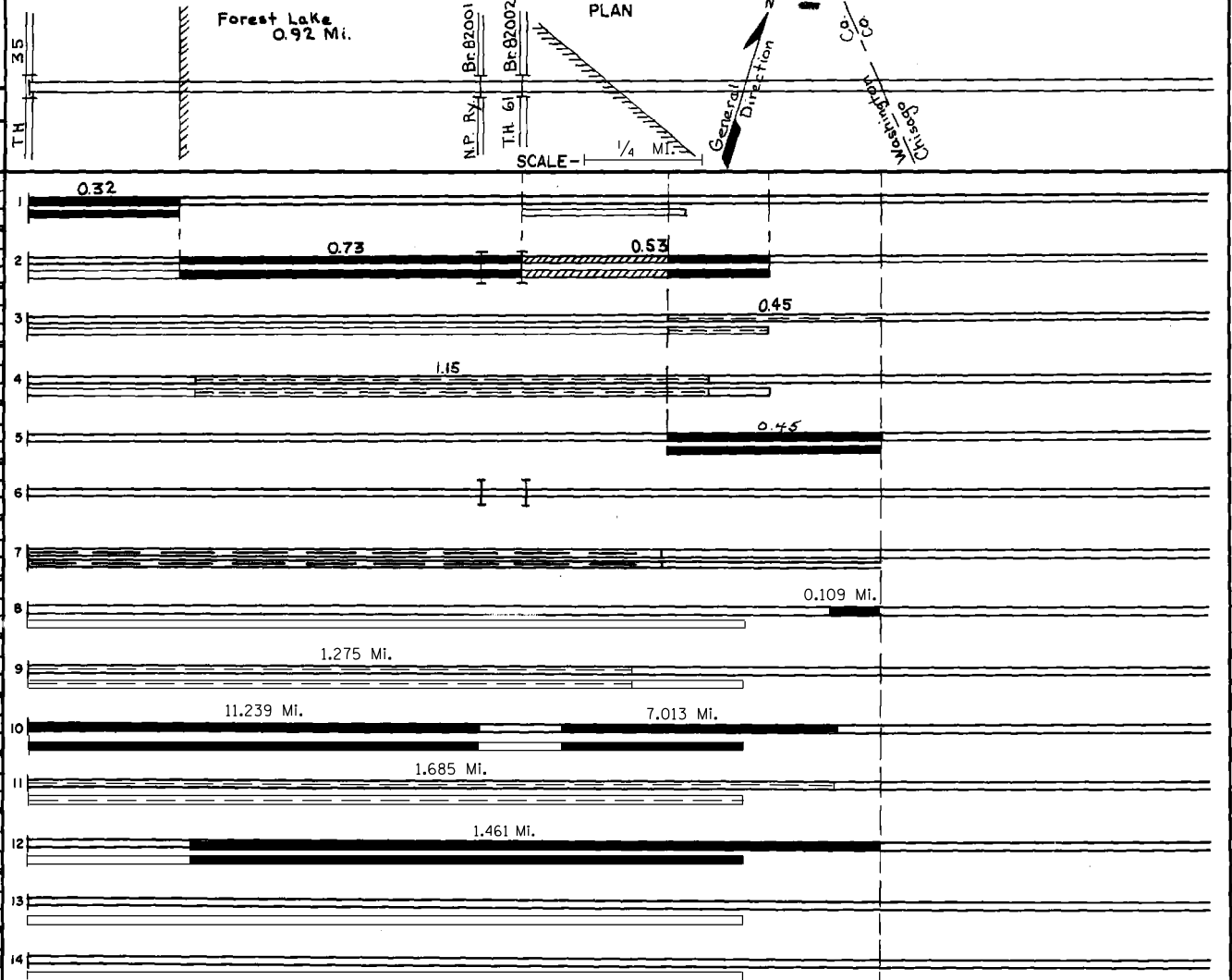

YEARS		TOTAL MILES	UNINCORPORATED		INCORPORATED		RURAL		URBAN	
FROM	TO		RDWY. MI.	BR. MI.	RDWY. MI.	BR. MI.	RDWY. MI.	BR. MI.	RDWY. MI.	BR. MI.
1951	1968	0.85	0.57	0.00	0.28	0.00	0.57	0.00	0.28	0.00
1969		1.81	0.89	0.00	0.92	0.10	0.89	0.00	0.82	0.10

REMARKS: Layout is to scale as of 1969