

TWO-LANE, TWO-WAY
LESS THAN 400 ADT
WITHOUT MARKINGS

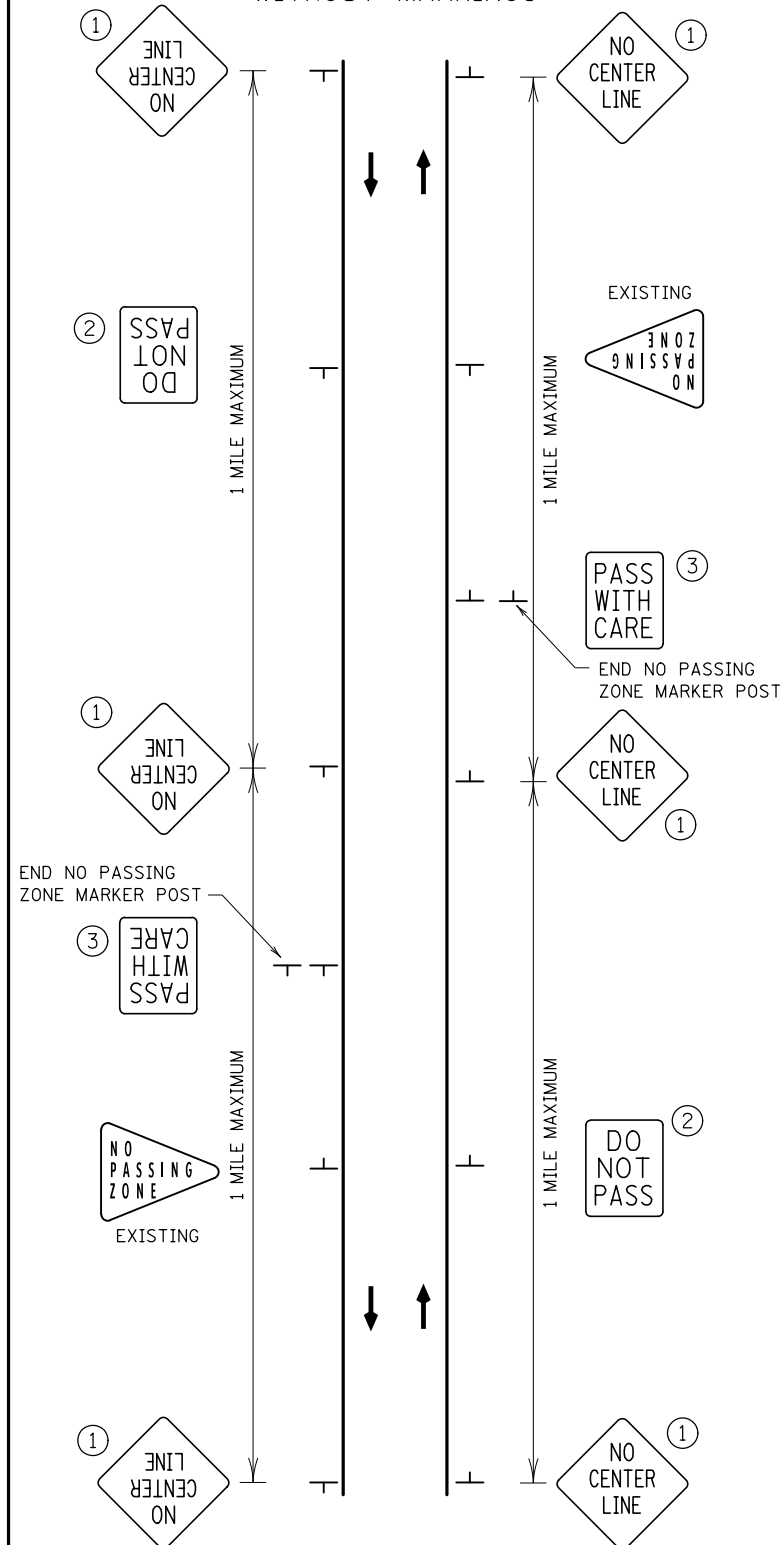

TWO-LANE, TWO-WAY

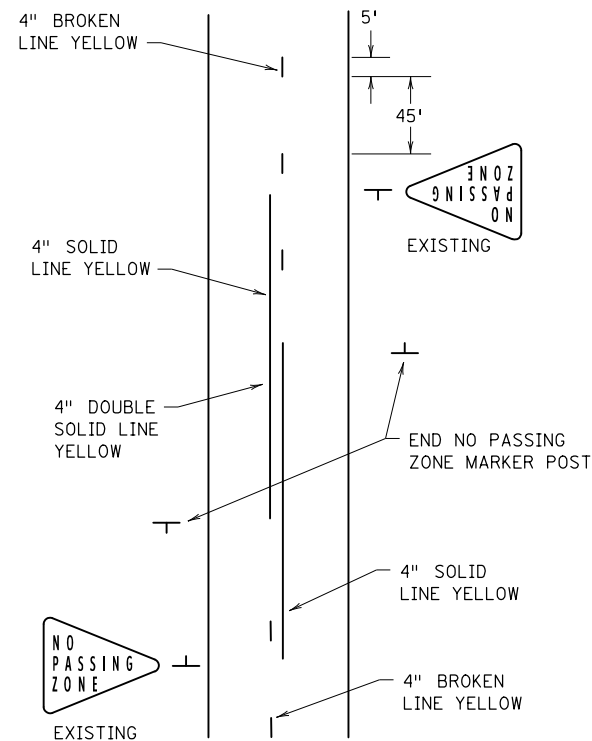

MULTI-LANE, UNDIVIDED

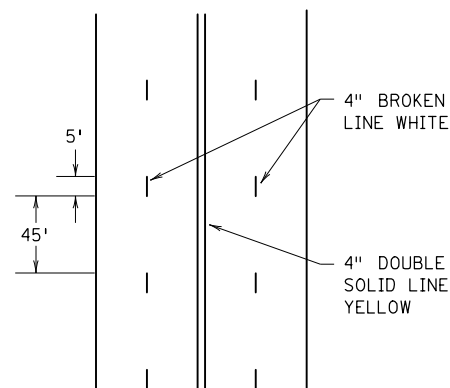

MULTI-LANE, DIVIDED

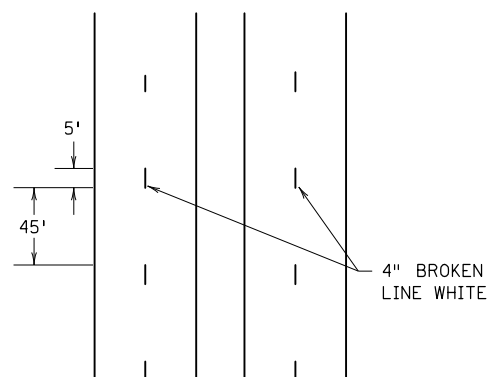

GENERAL NOTES:

SEE MnDOT SPEC. 2580 (INTERIM PAVEMENT MARKING).

DO NOT OPEN ANY ROADWAY SEGMENT TO TRAFFIC UNLESS THE FOLLOWING MARKINGS (INTERIM OR PERMANENT) ARE IN PLACE: CENTERLINE MARKINGS (INCLUDING NO PASSING ZONES), FLUSH MEDIANS (EXCLUDING CROSSHATCHING), AND LANE LINE (INCLUDING TURN AND AUXILIARY LANE LINES). THIS REQUIREMENT IS WAIVED FOR TANGENT ROAD SEGMENTS LESS THAN 350' IN LENGTH AND CURVED ROAD SEGMENTS WITH DEGREES OF CURVE GREATER THAN 6 DEGREES FOR LESS THAN 50' IN LENGTH.

PLACE INTERIM BROKEN LINE PAVEMENT MARKINGS AT THE SAME CYCLE LENGTH AS FINAL PAVEMENT MARKINGS WITH A MINIMUM LENGTH OF 5 FEET; IF FINAL PAVEMENT MARKING PLAN IS NOT PROVIDED, THE CYCLE LENGTH SHALL BE 50'. PLACE INTERIM DOTTED LINE PAVEMENT MARKINGS AT THE SAME CYCLE LENGTH AND LINE LENGTH AS SHOWN IN THE PLAN; IF FINAL PAVEMENT MARKING PLAN IS NOT PROVIDED, THE CYCLE LENGTH SHALL BE 15' WITH A LINE LENGTH OF 3'.

FOR NO PASSING ZONE LOCATIONS, REFER TO THE SIGNING OR PAVEMENT MARKING PLAN; IF NEITHER IS PROVIDED, FOLLOW INPLACE NO PASSING ZONES.

WHEN PERMANENT PAVEMENT MARKINGS ARE TO BE MULTI-COMPONENT LIQUID AND PAINT IS USED FOR THE INTERIM MARKINGS, PLACE A 10 MIL THICK LAYER OF PAINT. REMOVAL OF THE 10 MIL LAYER OF PAINT IS NOT REQUIRED PRIOR TO PLACING THE MULTI-COMPONENT LIQUID. IF THE LAYER OF PAINT IS GREATER THAN 10 MIL, REMOVE THE PAINT PRIOR TO PLACING THE MULTI-COMPONENT LIQUID.

PLACE INTERIM MARKINGS ON THE FINAL PERMANENT PAVEMENT SURFACE SUCH THAT THEY WILL BE FULLY COVERED BY THE PERMANENT PAVEMENT MARKINGS.

INTERIM PAVEMENT MARKINGS SHOULD NOT BE LEFT INPLACE FOR MORE THAN 14 CALENDAR DAYS UNLESS THEY MEET THE REQUIREMENTS OF PERMANENT OR TEMPORARY MARKINGS.

USING SIGNING IN LIEU OF INTERIM PAVEMENT MARKINGS ON TWO-LANE, TWO-WAY ROADWAYS

ON ROADS WITH AN AVERAGE DAILY TRAFFIC (ADT) OF LESS THAN 400 VEHICLES, THE SIGNS AS SHOWN MAY BE USED IN LIEU OF PAVEMENT MARKINGS FOR UP TO 14 CALENDAR DAYS OR AS DIRECTED BY THE ENGINEER.

- ① PLACE A "NO CENTER LINE" SIGN (W8-12, BLACK ON ORANGE) FOR EACH DIRECTION OF TRAVEL. PLACE ADDITIONAL SIGNS AT MAJOR INTERSECTIONS OR ONE MILE INCREMENTS, WHICHEVER IS LESS.
- ② IF NOT ALREADY INPLACE, PLACE A "DO NOT PASS" SIGN (R4-1) OPPOSITE OF EACH INPLACE "NO PASSING ZONE" SIGN (W14-3).
- ③ PLACE A "PASS WITH CARE" SIGN (R4-2) AT THE END OF EACH NO PASSING ZONE, ADJACENT TO THE END OF NO PASSING ZONE MARKER POST.

USING TEMPORARY RAISED PAVEMENT MARKERS (TRPMS) AS INTERIM PAVEMENT MARKING

WHEN USING TRPMS AS INTERIM PAVEMENT MARKINGS, FOLLOW THE REQUIREMENTS BELOW UNLESS OTHERWISE DIRECTED BY THE ENGINEER.

USE DOUBLE-SIDED TRPMS ON TWO-LANE, TWO-WAY ROADS.

BROKEN LINE: USE 3 TRPMS PER 10' BROKEN LINE, 5' SPACING WITH A 40' GAP.

SOLID LINE: USE CONTINUOUS TRPMS; 10' SPACING FOR TANGENTS AND CURVES UNDER 6 DEGREES; 5' SPACING FOR CURVES ≥6 DEGREES, GRADES >5 PERCENT, OR CONCRETE PAVEMENTS.

DOUBLE SOLID LINE: USE TWO CONTINUOUS TRPMS 4" APART, 10' SPACING ON TANGENTS AND CURVES UNDER 6 DEGREES; 5' SPACING FOR CURVES ≥6 DEGREES, GRADES >5 PERCENT, OR CONCRETE PAVEMENTS.

SIMULATING A SOLID LINE AND A BROKEN LINE (50' CYCLE) WITH TRPMS

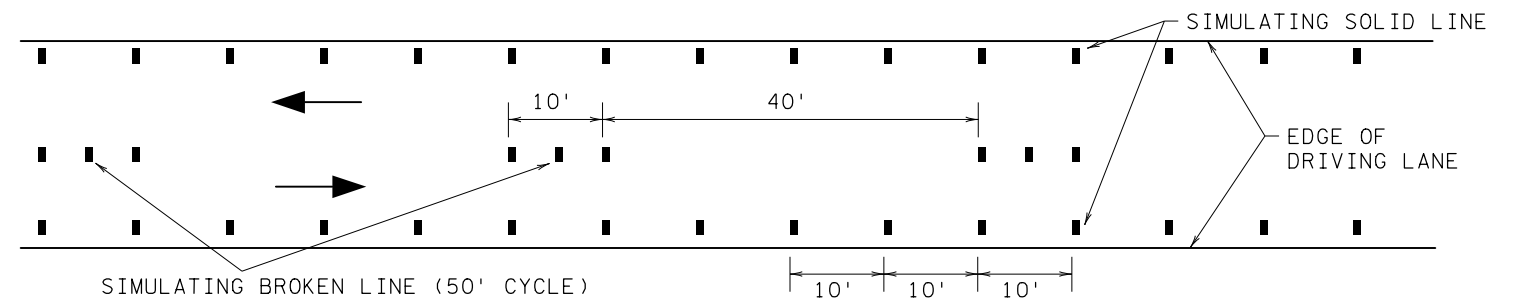

REVISION:
APPROVED: OCTOBER 10, 2019
Brian Sobenson
BRIAN SOBENSON
STATE TRAFFIC ENGINEER

m
MINNESOTA
DEPARTMENT
OF
TRANSPORTATION

STANDARD PLAN 5-297.801 1 OF 1
Peter A Harff
PETER A. HARFF
STATE DESIGN ENGINEER
APPROVED: 10-10-2019
REVISED:

INTERIM PAVEMENT MARKINGS AND SIGNING

STATE PROJ. NO. (T.H.) SHEET NO. OF SHEETS