

NOT TO SCALE

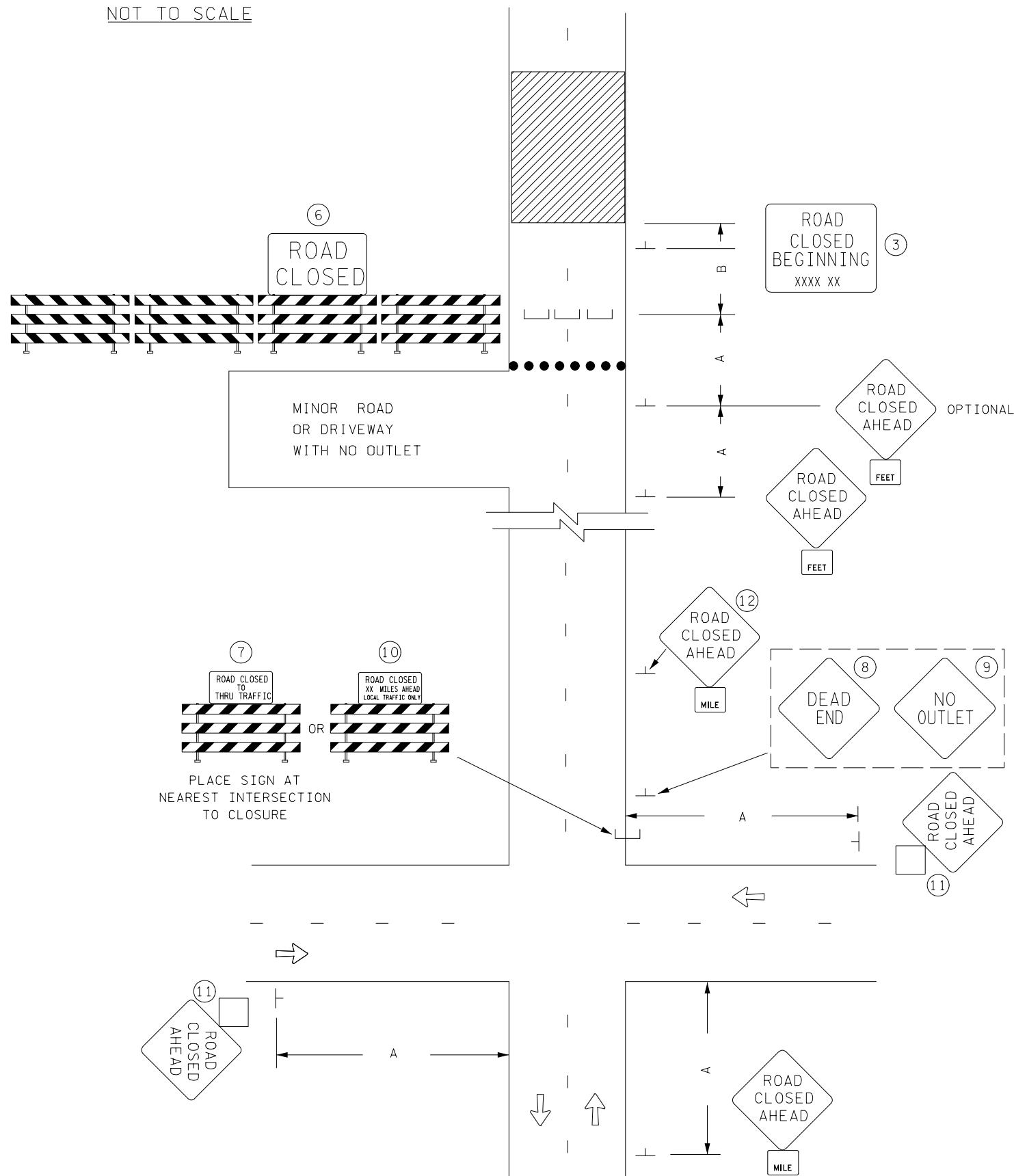

TYPICAL SIGNING FOR ROAD CLOSURE  
SHORT AND LONG TERM

POSTED SPEED LIMIT PRIOR TO WORK STARTING (MPH)	SPACING OF CHANNELIZING DEVICES (G) FEET	SPACING OF ADVANCE WARNING SIGNS (A) FEET	DECISION SIGHT DISTANCE FEET	TAPER LENGTH (L) FEET	SHIFTING TAPER (L/2) FEET	TYPICAL SHOULDER TAPER (L/3) FEET	BUFFER SPACE (B) FEET
0 - 30	25	100	550	200	100	75	200
35 - 40		325	700	325	175	125	305
45 - 50		600	900	600	300	200	425
55	50	750	1200	700	350	250	500
60 - 65		1000	1400	800	400	275	650
70 - 75		1200	1600	900	450	300	820

ALL DISTANCES BASED ON 12 FT LANE WIDTHS.

DESIGNER NOTES:

TYPICAL APPLICATION FOR REFERENCE ONLY, NOT TO BE INSERTED INTO PLAN.

1. INSERT SPACING CHART DISTANCES INTO LAYOUTS.
2. CONSIDER THE INSTALLATION OF A PCMS AND/OR G20-X2 OR SPECIAL SIGN, IF CONGESTION IS EXPECTED, IF ADVANCE SIGNING TO DIVERT TRAFFIC IS NEEDED OR OTHER CONDITIONS DETERMINED BY THE DESIGNER.
3. CONSIDER THE INSTALLATION OF A PCMS AND/OR G20-X1 SIGN (MODIFIED) OR G20-X2 SIGN FOR SEVEN DAY ADVANCE WARNING OF RESTRICTION.
4. COVER OR MODIFY ALL DIRECTIONAL SIGNING AFFECTED BY ANY TURN RESTRICTIONS. INCLUDE SIGN MODIFICATIONS, COVERS OR REMOVALS IN TRAFFIC CONTROL PLAN.
5. ALL DEVICES ARE SHOWN FOR ONE DIRECTION. DEVICES FOR THE OTHER DIRECTION SHOULD BE SIMILAR.
6. CLOSE ROAD AT LAST DRIVEWAY OR INTERSECTION WHERE THERE IS NO PUBLIC ACCESS BEYOND. BARRICADES SHALL SPAN ENTIRE ROADWAY INCLUDING TRAVERSABLE SHOULDERS.
7. "ROAD CLOSED TO THRU TRAFFIC" MAY BE PLACED ON THE CENTERLINE; STRIPES ON BARRICADE SHALL SLOPE DOWNWARD TOWARD THE APPROPRIATE TRAFFIC DIRECTION (FOR BOTH DIRECTIONS OF THE ROADWAY).
8. OPTIONAL - THE "DEAD END" SIGN SHALL BE USED ONLY WHEN THERE IS A DEAD END AND THERE ARE NO ALTERNATE THROUGH ROUTES PAST THIS POINT.
9. OPTIONAL - THE "NO OUTLET" SIGN SHALL BE USED ONLY WHEN THERE ARE NO OUTLETS OR ALTERNATE THROUGH ROUTES PAST THIS POINT.
10. USE WHEN 2 MILES OR GREATER TO CLOSURE.
11. OPTIONAL SIGN ASSEMBLY - IF USED, INCLUDE PLAQUE WITH ROUTE MARKER OR STREET NAME OF CLOSED ROADWAY. PLACE PLAQUE ON UPPER CORNER OF TRAFFIC SIDE OF WARNING SIGN.
12. USE WHEN APPROPRIATE.

● DRUMS