

NOT TO SCALE

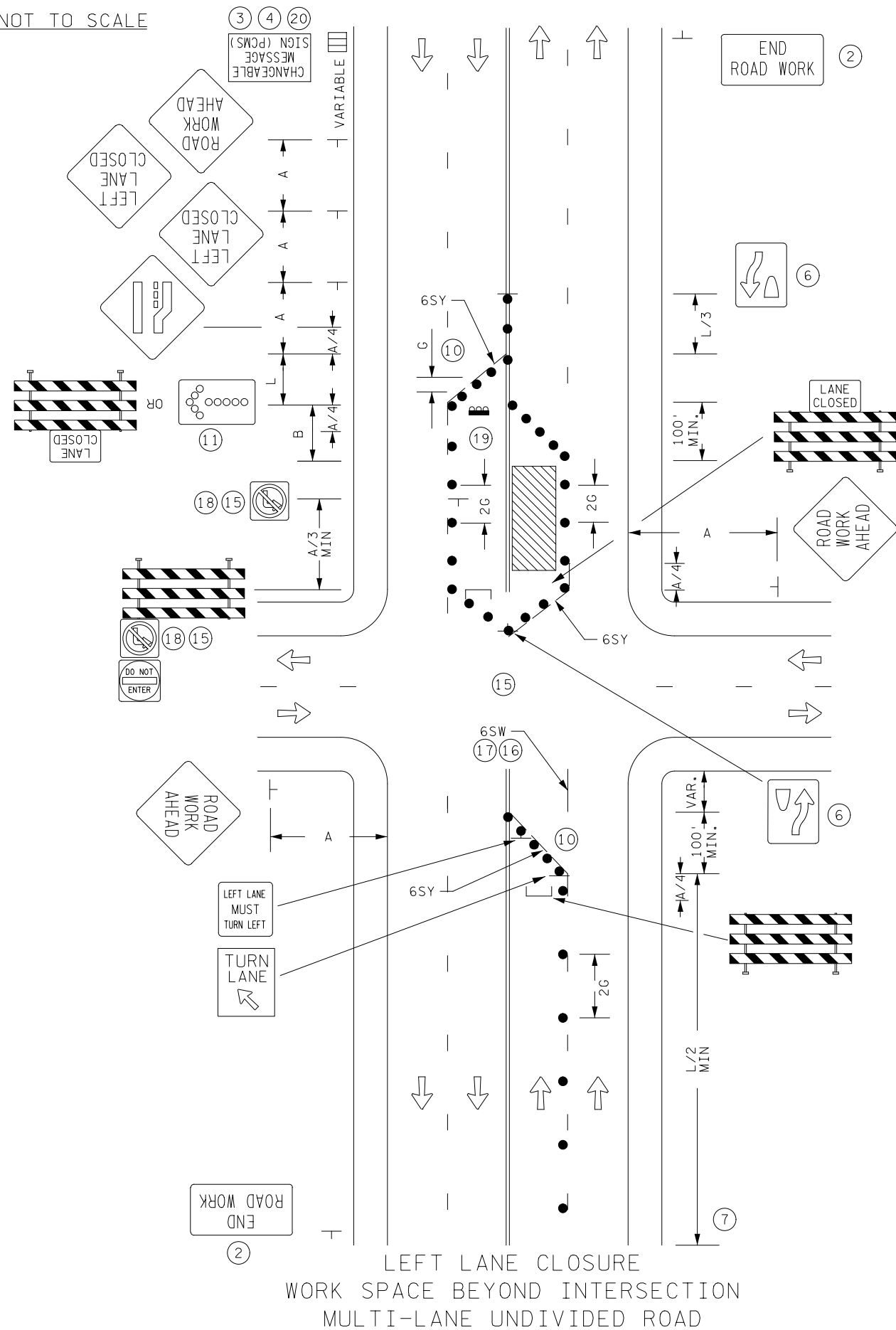

LEFT LANE CLOSURE
WORK SPACE BEYOND INTERSECTION
MULTI-LANE UNDIVIDED ROAD

POSTED SPEED LIMIT PRIOR TO WORK STARTING (MPH)	SPACING OF CHANNELIZING DEVICES (G) FEET	SPACING OF ADVANCE WARNING SIGNS (A) FEET	DECISION SIGHT DISTANCE FEET	TAPER LENGTH (L) FEET	SHIFTING TAPER (L/2) FEET	TYPICAL SHOULDER TAPER (L/3) FEET	BUFFER SPACE (B) FEET
0 - 30	25	100	550	200	100	75	200
35 - 40		325	700	325	175	125	305
45 - 50	50	600	900	600	300	200	425
55		750	1200	700	350	250	500
60 - 65		1000	1400	800	400	275	650
70 - 75		1200	1600	900	450	300	820

ALL DISTANCES BASED ON 12 FT LANE WIDTHS.

DESIGNER NOTES

TYPICAL APPLICATION FOR REFERENCE ONLY, NOT TO BE INSERTED INTO PLAN.

1. INSERT SPACING CHART DISTANCES INTO LAYOUTS.
2. DETERMINE IF "END ROAD WORK" SIGNS ARE NEEDED.
3. CONSIDER THE INSTALLATION OF A PCMS AND/OR G20-X2 OR SPECIAL SIGN IF CONGESTION IS EXPECTED, IF ADVANCE SIGNING TO DIVERT TRAFFIC IS NEEDED, OR OTHER CONDITIONS DETERMINED BY THE ENGINEER.
4. CONSIDER THE INSTALLATION OF A PCMS AND/OR G20-X1 SIGN (MODIFIED) OR G20-X2 SIGN FOR SEVEN DAY ADVANCE WARNING OF RESTRICTION.
5. FOR ANY EXCAVATION OR DROP-OFF IN EXCESS OF 12 IN., SEE THE MINNESOTA DEPARTMENT OF TRANSPORTATION "TEMPORARY BARRIER GUIDANCE MANUAL".
6. OPTIONAL KEEP RIGHT SIGN, 12" x 18".
7. USE APPROPRIATE LANE CLOSURE LAYOUT.
8. COVER OR MODIFY ALL DIRECTIONAL SIGNING AFFECTED BY ANY TURN RESTRICTIONS. INCLUDE SIGN MODIFICATIONS, COVERS OR REMOVALS IN TRAFFIC CONTROL PLAN.
9. IF BACKUPS ARE EXPECTED CONSIDER USE OF "LANE CLOSURE WITH ZIPPER MERGE LAYOUT".
10. MASK OR REMOVE ALL CONFLICTING PAVEMENT MARKINGS. DETERMINE QUANTITY OF MARKINGS TO BE MASKED OR REMOVED FOR PAY ITEM QUANTITIES.
11. THE FLASHING ARROW BOARD SHALL BE USED WHEN THE POSTED SPEED LIMIT IS 45 MPH OR GREATER, AND SHALL BE PLACED AT THE END OF THE TAPER IN LIEU OF THE TYPE III BARRICADE ASSEMBLY.
12. SOLID LINE TEMPORARY PAVEMENT MARKINGS, WET REFLECTIVE OR SUPPLEMENTED WITH TEMPORARY RAISED PAVEMENT MAKERS AT 10' SPACING
13. COVER OR REMOVE ALL CONFLICTING INPLACE SIGNING.
14. WHEN IMPACTING PEDESTRIAN FACILITIES, ALTERNATE PEDESTRIAN ACCESS ROUTES MUST BE PROVIDED. SEE LAYOUT 6J-24 AND 6J-25 FOR GUIDANCE.
15. CONTACT APPROPRIATE ROAD AUTHORITY FOR SIGNAL TIMING MODIFICATIONS AND POSSIBLE TURN RESTRICTIONS BEFORE BEGINNING WORK AT ANY SIGNALIZED INTERSECTION.
16. PROVIDE LEFT TURN LANE NOT WHEN PROHIBITED AND SPACE PERMITS.
17. CONSIDER LEFT TURN LANE PLACEMENT BASED ON EXPECTED QUEUE LENGTHS.
18. USE IF LEFT TURNS ARE PROHIBITED.
21. LANE MAY BE CLOSED OPENED WHEN WORKERS ARE NOT PRESENT.
20. SEE FIELD MANUAL LAYOUT *7 FOR PROPER SHOULDER DELINEATION FOR TRAILER MOUNTED TRAFFIC CONTROL DEVICES.

● DRUMS

6SY = 6 INCH SOLID LINE YELLOW WET REFLECTIVE

— — — TEMPORARY WET REFLECTIVE PAVEMENT MARKING.