

NOT TO SCALE

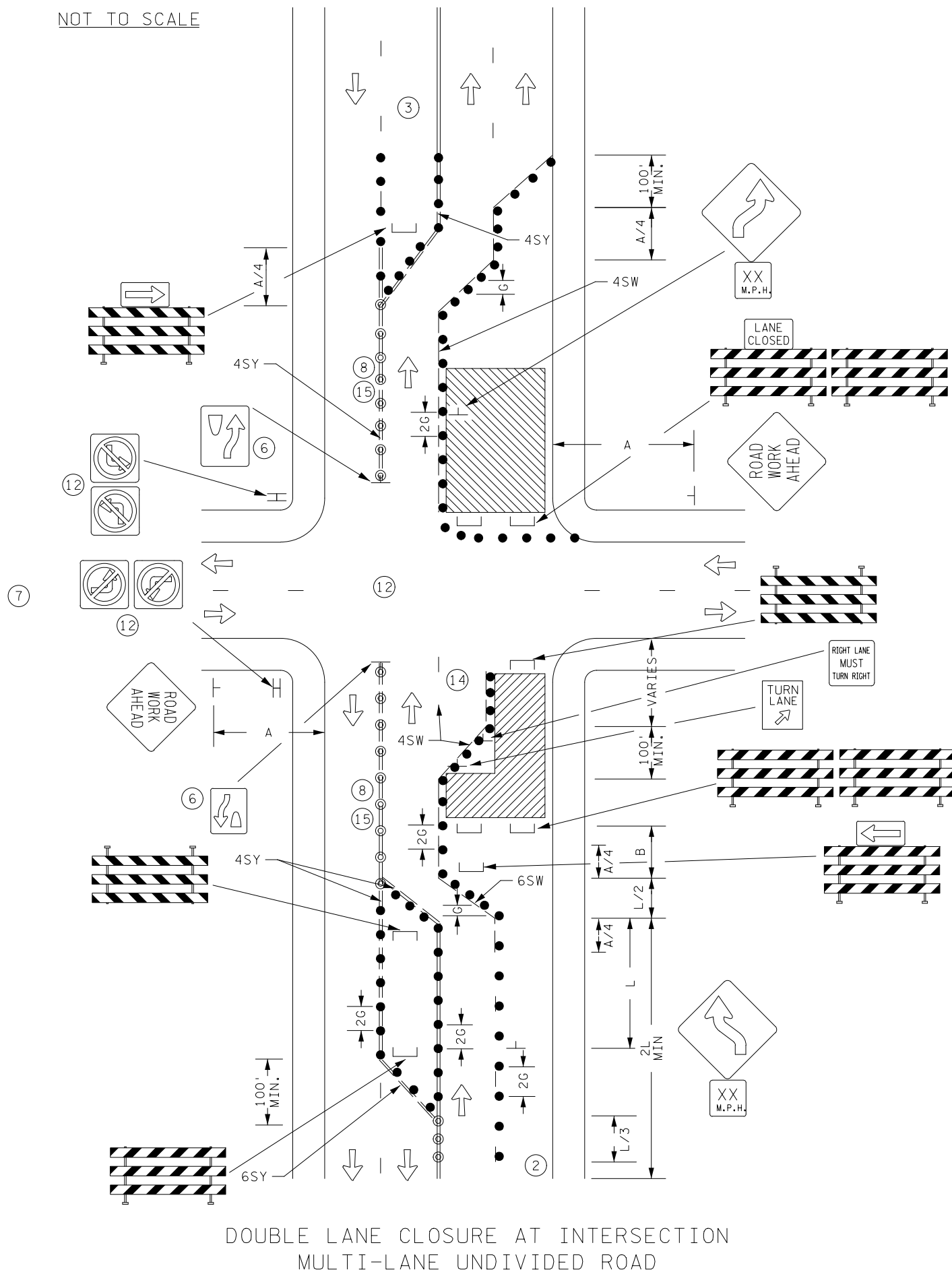

DOUBLE LANE CLOSURE AT INTERSECTION  
MULTI-LANE UNDIVIDED ROAD

POSTED SPEED LIMIT PRIOR TO WORK STARTING (MPH)	SPACING OF CHANNELIZING DEVICES (G) FEET	SPACING OF ADVANCE WARNING SIGNS (A) FEET	DECISION SIGHT DISTANCE FEET	TAPER LENGTH (L) FEET	SHIFTING TAPER (L/2) FEET	TYPICAL SHOULDER TAPER (L/3) FEET	BUFFER SPACE (B) FEET
0 - 30	25	100	550	200	100	75	200
35 - 40		325	700	325	175	125	305
45 - 50	50	600	900	600	300	200	425
55		750	1200	700	350	250	500
60 - 65		1000	1400	800	400	275	650
70 - 75		1200	1600	900	450	300	820

ALL DISTANCES BASED ON 12 FT LANE WIDTHS.

DESIGNER NOTES:

TYPICAL APPLICATION FOR REFERENCE ONLY, NOT TO BE INSERTED INTO PLAN.

1. INSERT SPACING CHART DISTANCES INTO LAYOUTS.
2. FOR THE PLACEMENT OF ADVANCE WARNING SIGNS, SEE LONG TERM TYPICAL APPLICATION "RIGHT LANE CLOSURE MULTI-LANE UNDIVIDED".
3. FOR THE PLACEMENT OF ADVANCE WARNING SIGNS, SEE LONG TERM TYPICAL APPLICATION "LEFT LANE CLOSURE MULTI-LANE UNDIVIDED".
4. FOR ANY EXCAVATION OR DROP-OFF IN EXCESS OF 12 IN., SEE THE MINNESOTA MANUAL DEPARTMENT OF TRANSPORTATION "TEMPORARY BARRIER GUIDANCE MANUAL".
5. ALL TEMPORARY PAVEMENT MARKINGS SHALL BE WET REFLECTIVE MATERIAL.
6. OPTIONAL KEEP RIGHT SIGN, 12" x 18".
7. MASK OR REMOVE ALL CONFLICTING PAVEMENT MARKINGS. DETERMINE QUANTITY OF MARKINGS TO BE MASKED OR REMOVED FOR PAY ITEM QUANTITIES.
8. SPACING FOR SURFACE MOUNTED DELINEATORS ARE G/2 FOR 250' IN ADVANCE OF INTERSECTION. SPACING FOR SURFACE MOUNTED DELINEATORS MAY BE INCREASED TO 2G WHEN GREATER THAN 250' FROM INTERSECTION.
9. SOLID LINE TEMPORARY PAVEMENT MARKINGS, WET REFLECTIVE OR SUPPLEMENTED WITH TEMPORARY RAISED PAVEMENT MAKERS AT 10' SPACING
10. COVER OR REMOVE ALL CONFLICTING INPLACE SIGNING.
11. WHEN IMPACTING PEDESTRIAN FACILITIES, ALTERNATE PEDESTRIAN ACCESS ROUTES MUST BE PROVIDED. SEE LAYOUT 6J-24 AND 6J-25 FOR GUIDANCE.
12. CONTACT APPROPRIATE ROAD AUTHORITY FOR SIGNAL TIMING, SIGNAL HEAD LOCATION, POSSIBLE TURN RESTRICTIONS, OR OTHER MODIFICATIONS BEFORE BEGINNING WORK AT ANY SIGNALIZED INTERSECTION.
13. COVER OR MODIFY ALL DIRECTIONAL SIGNING AFFECTED BY ANY TURN RESTRICTIONS. INCLUDE SIGN MODIFICATIONS, COVERS OR REMOVALS IN TRAFFIC CONTROL PLAN.
14. CONSIDER RIGHT TURN LANE PLACEMENT BASED ON EXPECTED QUEUE LENGTHS AND IF NOT PROHIBITED.
15. MAY SUBSTITUTE 4" DY LINE WITH TEMPORARY RAISED PAVEMENT MARKERS, DOUBLE SIDED PLACED 4" APART AT 10' SPACING.

- ⊙ SURFACE MOUNTED DELINEATOR      4DY = 4 INCH DOUBLE SOLID LINE YELLOW WET REFLECTIVE
- DRUMS      4SW = 4 INCH SOLID LINE WHITE WET REFLECTIVE
- 6SW = 6 INCH SOLID LINE WHITE WET REFLECTIVE
- 6DY = 6 INCH DOUBLE SOLID LINE YELLOW WET REFLECTIVE
- 6DW = 6 INCH DOUBLE SOLID LINE WHITE WET REFLECTIVE
- — — TEMPORARY WET REFLECTIVE PAVEMENT MARKING.