

NOT TO SCALE

④

EMERGENCY PULL OFF		
STAGE	SITE NO.	STA. TO STA.

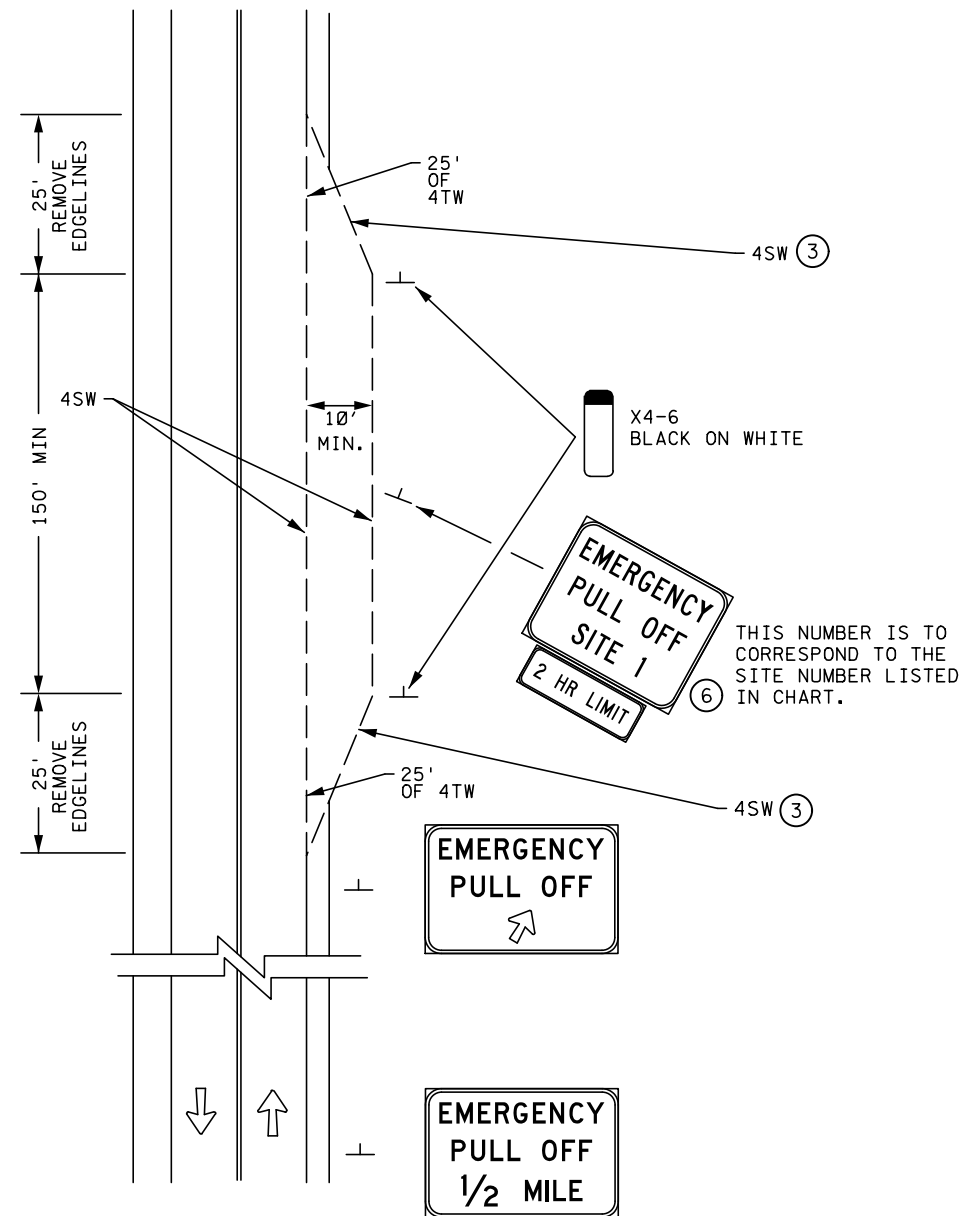

EMERGENCY PULL OFF
 MAY BE USED ON DIVIDED HIGHWAY OR TWO-LANE,
 TWO-WAY ROADS WHERE SHOULDERS ARE LESS THAN
 6 FEET WIDE AND RESTRICTION CONTINUES FOR MORE
 THAN 3/4 MILE

DESIGNER NOTES:

TYPICAL APPLICATION FOR REFERENCE ONLY, NOT TO BE INSERTED INTO PLAN.

1. MASK OR REMOVE ALL CONFLICTING PAVEMENT MARKINGS. DETERMINE QUANTITY OF MARKINGS TO BE MASKED OR REMOVED FOR PAY ITEM QUANTITIES.
2. ALL TEMPORARY PAVEMENT MARKINGS SHALL BE A WET REFLECTIVE MATERIAL.
- ③ CONTINUE TAPER TO IN PLACE EDGELINE. DO NOT STRIPE IF EMERGENCY PULL OFF IS NOT A PAVED SURFACE
- ④ EMERGENCY PULL OFF SITE NUMBER SHOULD CORRESPOND TO THE NEAREST MILE REFERENCE POINT NUMBER WHENEVER POSSIBLE.
5. GEOMETRIC CONDITIONS OF EMERGENCY PULL OFFS ARE SUBJECT TO SIGHT CONDITIONS IF TEMPORARY BARRIER IS USED TAPER LENGTHS MUST BE EXTENDED.
- ⑥ THIS NUMBER IS TO CORRESPOND TO THE SITE NUMBER LISTED IN CHART.

4SW - 4 INCH SOLID LINE WHITE WET REFLECTIVE
 4TW - 4 INCH DOTTED LINE WHITE WET REFLECTIVE
 — — — . TEMPORARY WET REFLECTIVE PAVEMENT MARKING.