

NOT TO SCALE

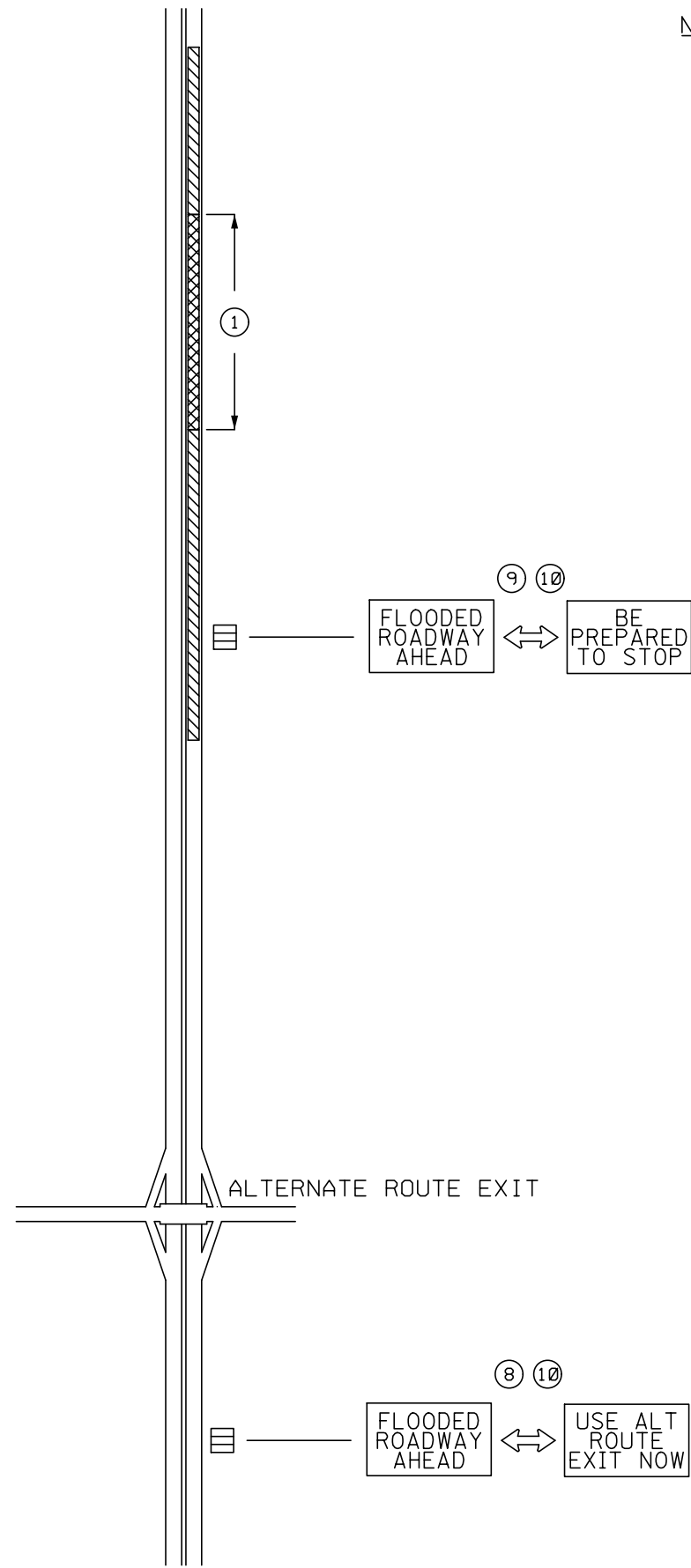

HAZARDOUS ROADWAY WARNING SYSTEM

DESIGNER NOTES:

TYPICAL APPLICATION FOR REFERENCE ONLY, NOT TO BE INSERTED INTO PLAN.

- ① AREA OF CONCERN.
2. ADVANCE WARNING SIGNS AND OTHER STANDARD TEMPORARY TRAFFIC CONTROL DEVICES HAVE NOT BEEN SHOWN ON THIS LAYOUT.
3. ANALYSIS SHOULD BE DONE AHEAD OF TIME FOR SIGNING PLACEMENT AND PROPER PCMS FUNCTIONING.
4. CONSIDERATION SHOULD BE GIVEN TO POSTING AN ALTERNATE ROUTE.
6. MULTIPLE PCMS LOCATIONS MAY BE DEPLOYED DEPENDING UPON AVAILABILITY OF ALTERNATE ROUTES.
- 7 APPROVED CMS MESSAGES SHOULD BE SHOWN ON THE TTC PLANS AND LISTED IN THE SPECIAL PROVISIONS. APPROXIMATE CMS LOCATIONS SHOULD ALSO BE SHOWN ON THE TTC PLANS. ALL CMS DISPLAYS SHOULD BE BLANK OR USED FOR ANOTHER ITS SYSTEM WHEN HAZARDOUS ROADWAY WARNING NOTIFICATION MESSAGES ARE NOT WARRANTED.
- ⑧ WHEN PCMS DEVICES ARE USED, THE TWO PART MESSAGE SHOULD READ:
--FLOODED ROADWAY AHEAD - - USE ALT ROUTE EXIT NOW--
- ⑨ WHEN PCMS DEVICES ARE USED, THE TWO PART MESSAGE SHOULD READ:
--FLOODED ROADWAY AHEAD - - BE PREPARED TO STOP--
- ⑩ ALL DISPLAYS SHOULD BE BLANK WHEN MESSAGES ARE NOT WARRANTED.